

CITY OF VISALIA
315 East Acequia Avenue Visalia, CA 93291

CHANGE ORDER FORM

Riggin Avenue Widening & Improvements Project

Change Order No.: 7 City Project No.: 3010-72000/CP0398-999
 Submitted by: Bryce Nagel Federal No.: N/A
 Date Submitted: ~~May 18, 2026~~ 05/20/26 Purchase Order No.: PO4217
 Committee Review Date: ~~May 20, 2026~~ 05/27/26 Package No. of Pages: 7

Change Requested by: Engineer Contractor Attachments: Specifications Plans Exhibits

To: **Agee Construction Corporation** Contractor

You are directed to make the following changes from the plans and specifications or do the following described work not included in the plans and specifications for this contract. **NOTE: This change order is not effective until approved by the Engineer.**

DESCRIPTION OF WORK:

Description of work to be done, estimate of quantities and prices to be paid. (Segregate between additional work at contract price, agreed price and force account.) Unless otherwise stated, rates for rental of equipment cover only such time as equipment is actually used and no allowance will be made for idle time. The last percentage shown is the net accumulated increase or decrease from the original quantity in the Bid Item List.

Categories: E&O=Errors & Omissions; UT=Utilities; BQ=Balance of Quantities; UN=Unforeseen; CofS=Owner Directed Change of Scope

| Item No. | Category | Description of Change Order | Net increase | *Net decrease | Total Change |
|------------------------------------|----------|---|---------------------|-----------------------|---------------------|
| 1 | CofS | Structural Section Change at Shirk & Riggin Intersection (Class II Aggregate Base) | \$418,280.68 | \$0.00 | \$418,280.68 |
| 2 | CofS/BQ | Bid Item #42 - 14.5" Full Depth Reclamation with Cement (FDR-C) (F): -6,360.17 SY @ \$9.00/SY | \$0.00 | (\$57,241.53) | (\$57,241.53) |
| 3 | CofS/BQ | Bid Item #43 - Cement for FDR-C Method (increased to 4.5%): -76.08 TN @ \$230.00/TN | \$0.00 | (\$17,498.40) | (\$17,498.40) |
| 4 | CofS/BQ | Bid Item #68 - 14.5" Full Depth Reclamation with Cement (FDR-C) (F): -77.0 SY @ \$9.00/SY | \$0.00 | (\$693.00) | (\$693.00) |
| 5 | CofS/BQ | Bid Item #69 - Cement for FDR-C Method (increased to 4.5%): -2.0 TN @ \$230.00/TN | \$0.00 | (\$460.00) | (\$460.00) |
| 6 | CofS/BQ | Bid Item #84 - 14.5" Full Depth Reclamation with Cement (FDR-C) (F): -2,652.0 SY @ \$9.00/SY | \$0.00 | (\$23,868.00) | (\$23,868.00) |
| 7 | CofS/BQ | Bid Item #85 - Cement for FDR-C Method (increased to 4.5%): -80.0 TN @ \$230.00/TN | \$0.00 | (\$18,400.00) | (\$18,400.00) |
| 8 | CofS/BQ | Bid Item #41 - Hot Mix Asphalt (Type A, 3/4"): -519.0 TN @ \$98.00/TN | \$0.00 | (\$50,862.00) | (\$50,862.00) |
| 9 | CofS/BQ | Bid Item #67 - Hot Mix Asphalt (Type A, 3/4"): -600.0 TN @ \$98.00/TN | \$0.00 | (\$58,800.00) | (\$58,800.00) |
| 10 | CofS/BQ | Bid Item #83 - Hot Mix Asphalt (Type A, 3/4"): 138.00 TN @ \$98.00/TN | \$13,524.00 | \$0.00 | \$13,524.00 |
| 11 | CofS/BQ | Bid Item #34 - Asphalt Dike: -23.0 LF @ \$14.00/LF | \$0.00 | (\$322.00) | (\$322.00) |
| 12 | CofS/BQ | Bid Item #55 - Asphalt Dike: -117.0 LF @ \$14.00/LF | \$0.00 | (\$1,638.00) | (\$1,638.00) |
| 13 | CofS/BQ | Bid Item #79 - Asphalt Dike: -839.0 LF @ \$14.00/LF | \$0.00 | (\$11,746.00) | (\$11,746.00) |
| 14 | CofS/BQ | Bid Item #10 - Sawcut & Remove Existing Asphalt Pavement (F): -4,400 SF @ \$0.25/SF | \$0.00 | (\$1,100.00) | (\$1,100.00) |
| Total Cost of Change Order: | | | \$431,804.68 | (\$242,628.93) | \$189,175.75 |

* note: enter "decrease" as a negative number (i.e. -1000)

Item Details:

CITY OF VISALIA
 315 East Acequia Avenue Visalia, CA 93291

CHANGE ORDER FORM

Riggin Avenue Widening & Improvements Project

| | | | |
|------------------------|--------------------------------|-----------------------|------------------------------|
| Change Order No.: | <u>7</u> | City Project No.: | <u>3010-72000/CP0398-999</u> |
| Submitted by: | <u>Bryce Nagel</u> | Federal No.: | <u>N/A</u> |
| Date Submitted: | <u>May 18, 2026</u> | Purchase Order No.: | <u>PO4217</u> |
| Committee Review Date: | <u>May 20, 2026</u> | Package No. of Pages: | <u>17</u> |

Note: Include Method of Payment, Location & Limits of Work, Description of Work to be Done, Applicable Specification Changes, Plan Sheet Changes, and Exhibits to provide clear direction. Attach all supporting documents for CO Committee.

ITEM 1: Structural Section Change at Shirk & Riggin Intersection (Class II Aggregate Base): AGREED PRICE

In accordance with Section 4-10 "Changes" of the City of Visalia's Standard Specifications, the Contractor shall replace the 14.5" FDR-C base section with a 17" Class II Aggregate Base section at the Shirk and Riggin intersection as shown on sheets 15 & 16 of 63, and included as sheets 5 & 6 of 7 of this contract change order. For this work, the Contractor shall accept and receive the lump sum amount of \$418,280.68. This amount constitutes full and complete compensation for providing all labor, material, equipment, tools and incidentals, including all markups by reason of this change and no additional compensation will be provided.

ITEM 2: Bid Item #42 - 14.5" Full Depth Reclamation with Cement (FDR-C) (F): BID QUANTITY

Bid Item #42 - 14.5" Full Depth Reclamation with Cement (FDR-C) (F) is reduced due to changes stated in Item #1. A total of -6,360.17 SY @ \$9.00/SY is removed from the Contract.

The revised final quantity for Bid Item #42 - 14.5" Full Dept Reclamation with Cement (FDR-C) (F) will be 28,502.0 SY. You accept this quantity as the final payment for the quantity shown on the Bid Item List, as modified by this change order and by previous change orders, including dimensions changed by the engineer.

ITEM 3: Bid Item #43 - Cement for FDR-C Method (Increased to 4.5%): BID QUANTITY

Bid Item #43 - Cement for FDR-C Method (Increased to 4.5%) is reduced due to changes stated in Item #1. A total of -76.08 TN @ \$230.00/TN is removed from the Contract. Payment for Bid Item #43 is based on the certified weight tickets per the Project Specifications.

ITEM 4: Bid Item #68 - 14.5" Full Depth Reclamation with Cement (FDR-C) (F): BID QUANTITY

Bid Item #68 - 14.5" Full Depth Reclamation with Cement (FDR-C) (F) is reduced due to changes stated in Item #1. A total of -77.0 SY @ \$9.00/SY is removed from the Contract.

The revised final quantity for Bid Item #68 - 14.5" Full Dept Reclamation with Cement (FDR-C) (F) will be 2,696.0 SY. You accept this quantity as the final payment for the quantity shown on the Bid Item List, as modified by this change order and by previous change orders, including dimensions changed by the engineer.

ITEM 5: Bid Item #69 - Cement for FDR-C Method (Increased to 4.5%): BID QUANTITY

Bid Item #69 - Cement for FDR-C Method (Increased to 4.5%) is reduced due to changes stated in Item #1. A total of -2.0 TN @ \$230.00/TN is removed from the Contract. Payment for Bid Item #69 is based on the certified weight tickets per the Project Specifications.

ITEM 6: Bid Item #84 - 14.5" Full Depth Reclamation with Cement (FDR-C) (F): BID QUANTITY

Bid Item #84 - 14.5" Full Depth Reclamation with Cement (FDR-C) (F) is reduced due to changes stated in Item #1. A total of -2,652.0 SY @ \$9.00/SY is removed from the Contract.

The revised final quantity for Bid Item #84 - 14.5" Full Dept Reclamation with Cement (FDR-C) (F) will be 0.0 SY. You accept this quantity as the final payment for the quantity shown on the Bid Item List, as modified by this change order and by previous change orders, including dimensions changed by the engineer.

CITY OF VISALIA
315 East Acequia Avenue Visalia, CA 93291

CHANGE ORDER FORM
Riggin Avenue Widening & Improvements Project

| | | | |
|------------------------|-------------------------|-----------------------|-----------------------|
| Change Order No.: | 7 | City Project No.: | 3010-72000/CP0398-999 |
| Submitted by: | Bryce Nagel | Federal No.: | N/A |
| Date Submitted: | May 18, 2026 | Purchase Order No.: | PO4217 |
| Committee Review Date: | May 20, 2026 | Package No. of Pages: | 7 |

ITEM 7: Bid Item #85 - Cement for FDR-C Method (Increased to 4.5%): BID QUANTITY

Bid Item #85 - Cement for FDR-C Method (Increased to 4.5%) is reduced due to changes stated in Item #1. A total of -80.0 TN @ \$230.00/TN is removed from the Contract. Payment for Bid Item #85 is based on the certified weight tickets per the Project Specifications.

ITEM 8: Bid Item #41 - Hot Mix Asphalt (Type A, 3/4"): BID QUANTITY

In accordance with Secion 4-10 "Changes" of the City of Visalia Standard Specifications, the Contractor shall reduce the paving limits north of the Shirk and Riggin intersection as shown on Redlined Plan Sheet 17 of 63, included as sheet 7 of 7 of this contract change order. A total of -519.0 TN @ \$95.00/TN is removed from the Contract. Payment for Bid Item #41 is based on certified weight tickets per the Project Specifications and the City of Visalia's Standard Specifications.

ITEM 9: Bid Item #67 - Hot Mix Asphalt (Type A, 3/4"): BID QUANTITY

In accordance with Secion 4-10 "Changes" of the City of Visalia Standard Specifications, the Contractor shall reduce the paving limits north of the Shirk and Riggin intersection as shown on Redlined Plan Sheet 17 of 63, included as sheet 7 of 7 of this contract change order. A total of -600.0 TN @ \$95.00/TN is removed from the Contract. Payment for Bid Item #67 is based on certified weight tickets per the Project Specifications and the City of Visalia's Standard Specifications.

ITEM 10: Bid Item #83 - Hot Mix Asphalt (Type A, 3/4"): BID QUANTITY

In accordance with Secion 4-10 "Changes" of the City of Visalia Standard Specifications, the Contractor shall increase the paving limits east of the Shirk and Riggin intersection as shown on Redlined Plan Sheet 16 & 17 of 63, included as sheets 6 & 7 of 7 of this contract change order. A total of 138.0 TN @ \$95.00/TN is added from the Contract. Payment for Bid Item #83 is based on certified weight tickets per the Project Specifications and the City of Visalia's Standard Specifications.

ITEM 11: Bid Item #34 - Asphalt Dike: BID QUANTITY

In accordance with Secion 4-10 "Changes" of the City of Visalia Standard Specifications, the asphalt dike (type A) at the NE corner of Shirk and Riggin is removed from the contract as shown on Redlined Plan Sheet 17 of 63, included as sheet 7 of 7 of this contract change order. A total of -23.0 LF @ \$14.00/LF is removed from the Contract.

ITEM 12: Bid Item #55 - Asphalt Dike: BID QUANTITY

In accordance with Secion 4-10 "Changes" of the City of Visalia Standard Specifications, the asphalt dike (type A) from STA 64+88 - 73+21 is removed from the contract as shown on Redlined Plan Sheets 15 & 16 of 63, included as sheet 5 & 6 of 7 of this contract change order. A total of -117.0 LF @ \$14.00/LF is removed from the Contract.

ITEM 13: Bid Item #79 - Asphalt Dike: BID QUANTITY

In accordance with Secion 4-10 "Changes" of the City of Visalia Standard Specifications, the asphalt dike (type A) from STA 64+88 - 73+21 is removed from the contract as shown on Redlined Plan Sheets 15 & 16 of 63, included as sheet 5 & 6 of 7 of this contract change order. A total of -839.0 LF @ \$14.00/LF is removed from the Contract.

ITEM 14: Bid Item #10 - Sawcut & Remove Existing Asphalt Pavement (F): BID QUANTITY

In accordance with Secion 4-10 "Changes" of the City of Visalia Standard Specifications, the asphalt removal quantity is reduced due to the ongoing development at the Shirk and Riggin intersection. The Contractor is not required to remove the asphalt pavement from Shirk STA 11+80 - 13+87. A total of -4,400.0 SF @ \$0.25/SF is removed from the Contract.

The revised final quantity for Bid Item #10 – Sawcut & Remove Existing Asphalt Pavement (F) will be 154,424.0 SF. You accept this quantity as the final payment for the quantity shown on the Bid Item List, as modified by this change order and by previous change orders, including dimensions changed by the engineer.

CITY OF VISALIA
 315 East Acequia Avenue Visalia, CA 93291

CHANGE ORDER FORM

Riggin Avenue Widening & Improvements Project

Change Order No.: 7

City Project No.: 3010-72000/CP0398-999

Submitted by: Bryce Nagel

Federal No.: N/A

Date Submitted: ~~May 18, 2026~~

Purchase Order No.: PO4217

Committee Review Date: ~~May 20, 2026~~

Package No. of Pages: ~~10~~ 7

Original Contract Amount: \$8,098,281.00

Net cost of this Change Order: \$189,175.75

2.34% Increase / Decrease

Total cost of previous Change Orders: \$585,076.25

7.22% of Original Contract Amount

New Contract Amount: \$8,872,533.00

9.56% Over Original Contract Amount

Note: Change Order Increases greater than \$100,000 require City Council authorization.

Previously granted additional days: 49

Original Date of Completion per Contract: 2/27/2026

Contract work days added this CO: 0

New Date of Completion: 5/18/2026

CHANGE ORDER FORM
Riggin Avenue Widening & Improvements Project

| | | | |
|------------------------|---------------------|----------------------|------------------------------|
| Change Order No.: | <u>7</u> | City Project No.: | <u>3010-72000/CP0398-999</u> |
| Submitted by: | <u>Bryce Nagel</u> | Federal No.: | <u>N/A</u> |
| Date Submitted: | <u>May 18, 2026</u> | Purchase Order No.: | <u>PO4217</u> |
| Committee Review Date: | <u>May 20, 2026</u> | Package No. of Pages | <u>7</u> |

We the undersigned contractor, have given careful consideration to the change proposed and agree to provide equipment, furnish materials, and perform the work specified, and will accept as full payment the prices shown above.

NOTE: If you do not sign this order, you are directed to proceed with the ordered work. You may file a Request for Information within the time specified.

CONTRACTOR ACCEPTANCE BY

| | | |
|--|---|------------------------|
|  Signature | <u>John Gerwe / Estimator</u> Print Name & Title | <u>5/14/26</u> Date |
|--|---|------------------------|

SUBMITTED BY CONSTRUCTION MANAGER

| | | |
|--|---|------------------------|
|  Signature | <u>Kolton Walker - CM (NV5)</u> Print Name & Title | <u>5/15/26</u> Date |
|--|---|------------------------|

APPROVAL RECOMMENDED BY PROJECT ENGINEER

| | | |
|---|---|-------------------------|
|  Signature | <u>Bryce Nagel, Ass. Eng.</u> Print Name & Title | <u>05/20/26</u> Date |
|---|---|-------------------------|

ENGINEER APPROVAL BY SUPERVISOR/DEPART. HEAD

| | | |
|--|---|------------------------|
|  Signature | <u>Christopher Crawford, City Engineer, for Jason Huckleberry Eng. & Bldg. Director</u> | <u>5/21/26</u> Date |
|--|---|------------------------|

CHANGE ORDER COMMITTEE ACTION:

(note: Committee Chair to check appropriate action)

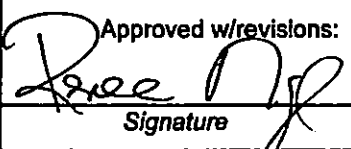
| | | |
|--|--|----------------------------------|
| Approved: <input checked="" type="checkbox"/> | Resubmit w/changes: <input type="checkbox"/> | Denied: <input type="checkbox"/> |
| Approved w/revisions: <input type="checkbox"/> | | |
|  Signature | <u>Renee Nagel Committee Chair</u> Print Name & Title | <u>5-27-26</u> Date |

CCO #7 = (Item Code #99 + Item Code #101) = (\$271,630.99 + \$76,936.24) * 20% MU = \$418,280.68

Estimate Summary

AGEE CONSTRUCTION CORPORATION

Job Code: J25-05 PCO

Description: Riggan Ave. Widening from Kelsey to Shirk, City of Visalia

From Cost Item: 0.2

To Cost Item: 99.3

| | | Cost Item | | | | | | | 271,630.99 |
|-------------------|--------------------------|--|--------------------|-------------|-------------|-------------|------------|-----------------------|------------|
| CBS Position Code | Quantity UM | Description | Days | UM/Day | Cost Source | Currency | Unit Cost | Total Cost | |
| 99 | 1.00 LS | Switch Structural Section, Open Shirk Early | 17.44 | 0.06 | Detail | U.S. Dollar | 311,620.35 | 311,620.35 | |
| 99.1 | 1.00 LS | construct each phase | 17.44 | 0.06 | Detail | U.S. Dollar | 311,620.35 | 311,620.35 | |
| 99.1.1 | 1.00 LS | ph1 SE corner | 3.50 | 0.29 | Detail | U.S. Dollar | 53,144.26 | 53,144.26 | |
| 99.1.1.1 | 1.00 LS | grind ex. ac to subgrade | 0.50 | 2.00 | Detail | U.S. Dollar | 9,832.03 | 9,832.03 | |
| 99.1.1.1.1 | 0.50 EA | grinder mob | 0.00 | 0.00 | Plug | U.S. Dollar | 800.00 | 400.00 | |
| 99.1.1.1.2 | 0.50 DA | grinder rental | 0.00 | 0.00 | Plug | U.S. Dollar | 5,100.00 | 2,550.00 | |
| 99.1.1.1.3 | 0.50 DA | grinder support | 0.50 | 1.00 | Detail | U.S. Dollar | 6,504.06 | 3,252.03 | |
| Resource Code | Description | Hours | Quantity UM | Currency | Unit Cost | Total Cost | | | |
| O-OF | OE Foreman w/Trk | 8.00 | 1.00 Hour | U.S. Dollar | | | | | |
| E140 | Blade-12 Ft., 140G | 4.00 | 1.00 Each (hourly) | U.S. Dollar | | | | | |
| OSKIP | Tractor-Box Scraper | 8.00 | 1.00 Hour | U.S. Dollar | | | | | |
| OCOMP8 | Cmpctr-08 TN PD, CA-15 | 8.00 | 1.00 Hour | U.S. Dollar | | | | | |
| O-GRC | Grade Checker | 4.00 | 1.00 Hour | U.S. Dollar | | | | | |
| LL01 | Laborer-Grp 1 | 4.00 | 1.00 Each (hourly) | U.S. Dollar | | | | | |
| EWATER2 | Water Trk-02M Gal (Bare) | 4.00 | 1.00 Each (hourly) | U.S. Dollar | | | | | |
| 99.1.1.1.5 | 19.00 LD | offhaul dirt, 1.1hr RT, 13bcy/LD | 0.00 | 0.00 | Detail | U.S. Dollar | 191.05 | 3,630.00 | |
| Resource Code | Description | Hours | Quantity UM | Currency | Unit Cost | Total Cost | | | |
| UHTDS | Trk-Semi Demo | | 22.00 HR | U.S. Dollar | 165.00 | 3,630.00 | | | |
| 99.1.1.2 | 4,814.00 SF | rip / compact subgrade, loss of production day | 0.25 | 19,256.00 | Detail | U.S. Dollar | 0.28 | 1,324.36 | |
| Resource Code | Description | Hours | Quantity UM | Currency | Unit Cost | Total Cost | | | |
| O-OF | OE Foreman w/Trk | 4.00 | 1.00 Hour | U.S. Dollar | | | | | |
| E140 | Blade-12 Ft., 140G | 2.00 | 1.00 Each (hourly) | U.S. Dollar | | | | | |
| OCOMP8 | Cmpctr-08 TN PD, CA-15 | 4.00 | 1.00 Hour | U.S. Dollar | | | | | |
| O-GRC | Grade Checker | 2.00 | 1.00 Hour | U.S. Dollar | | | | | |
| LL01 | Laborer-Grp 1 | 2.00 | 1.00 Each (hourly) | U.S. Dollar | | | | | |
| EWATER2 | Water Trk-02M Gal (Bare) | 2.00 | 1.00 Each (hourly) | U.S. Dollar | | | | | |
| 99.1.1.3 | 4,814.00 SF | finish subgrade, loss of production day | 0.75 | 6,418.67 | Detail | U.S. Dollar | 1.08 | 5,211.05 | |
| Resource Code | Description | Hours | Quantity UM | Currency | Unit Cost | Total Cost | | | |
| O-OF | OE Foreman w/Trk | 12.00 | 1.00 Hour | U.S. Dollar | | | | | |
| E140 | Blade-12 Ft., 140G | 6.00 | 1.00 Each (hourly) | U.S. Dollar | | | | | |
| O950 | Loader-3.5 CY, 950 | 12.00 | 1.00 Hour | U.S. Dollar | | | | | |
| OCOMP8 | Cmpctr-08 TN PD, CA-15 | 12.00 | 1.00 Hour | U.S. Dollar | | | | | |
| O-GRC | Grade Checker | 6.00 | 1.00 Hour | U.S. Dollar | | | | | |
| LL01 | Laborer-Grp 1 | 6.00 | 1.00 Each (hourly) | U.S. Dollar | | | | | |
| EWATER2 | Water Trk-02M Gal (Bare) | 6.00 | 1.00 Each (hourly) | U.S. Dollar | | | | | |

| Cost Item | | | | | | | | |
|-----------------------|--------------------------|---|--------------------|-------------------|-------------------|------------------------|----------------------|----------------------|
| CBS Position Code | Quantity UM | Description | Days | UM/Day | Cost Source | Currency | Unit Cost | Total Cost |
| 99.1.1.4 | 1.00 LS | sawcut so can pour island neat against ac | 0.00 | 0.00 | Plug | U.S. Dollar | 600.00 | 600.00 |
| 99.1.1.5 | 505.00 TN | ab | 1.00 | 505.00 | Detail | U.S. Dollar | 40.36 | 20,379.86 |
| 99.1.1.5.1 | 505.00 TN | buy / haul ab, 15.4" deep | 0.00 | 0.00 | Detail | U.S. Dollar | 25.94 | 13,101.34 |
| 99.1.1.5.1.1 | 505.00 TN | buy ab | 0.00 | 0.00 | Detail | U.S. Dollar | 18.94 | 9,566.34 |
| Resource Code | Description | Hours | Quantity UM | Currency | Unit Cost | Total Cost | | |
| MRB23/4 | Agg Base-3/4" Class 2 | | 505.00 TN | U.S. Dollar | 17.90 | 9,040.76 | | |
| ABENVIRO | AB ENVIRO FEE | | 30.03 LD | U.S. Dollar | 17.50 | 525.58 | | |
| 99.1.1.5.1.2 | 505.00 TN | haul ab | 0.00 | 0.00 | Detail | U.S. Dollar | 7.00 | 3,535.00 |
| Resource Code | Description | Hours | Quantity UM | Currency | Unit Cost | Total Cost | | |
| HAULABTRAN | HAUL AB TRANSFER | | 505.00 TN | U.S. Dollar | 7.00 | 3,535.00 | | |
| 99.1.1.5.2 | 505.00 TN | place / compact ab | 0.50 | 1,010.00 | Detail | U.S. Dollar | 6.39 | 3,226.60 |
| Resource Code | Description | Hours | Quantity UM | Currency | Unit Cost | Total Cost | | |
| O-OF | OE Foreman w/Trk | 8.00 | 1.00 Hour | U.S. Dollar | | | | |
| E140 | Blade-12 Ft., 140G | 4.00 | 1.00 Each (hourly) | U.S. Dollar | | | | |
| OROLL12 | Roller-12 TN DD, CB-534 | 8.00 | 1.00 Hour | U.S. Dollar | | | | |
| O-GRC | Grade Checker | 4.00 | 1.00 Hour | U.S. Dollar | | | | |
| LL01 | Laborer-Grp 1 | 8.00 | 2.00 Each (hourly) | U.S. Dollar | | | | |
| EWATER2 | Water Trk-02M Gal (Bare) | 4.00 | 1.00 Each (hourly) | U.S. Dollar | | | | |
| 99.1.1.5.3 | 4,814.00 SF | finish ab | 0.50 | 9,628.00 | Detail | U.S. Dollar | 0.84 | 4,051.92 |
| Resource Code | Description | Hours | Quantity UM | Currency | Unit Cost | Total Cost | | |
| O-OF | OE Foreman w/Trk | 8.00 | 1.00 Hour | U.S. Dollar | | | | |
| E140 | Blade-12 Ft., 140G | 4.00 | 1.00 Each (hourly) | U.S. Dollar | | | | |
| O950 | Loader-3.5 CY, 950 | 8.00 | 1.00 Hour | U.S. Dollar | | | | |
| OROLL12 | Roller-12 TN DD, CB-534 | 8.00 | 1.00 Hour | U.S. Dollar | | | | |
| O-GRC | Grade Checker | 4.00 | 1.00 Hour | U.S. Dollar | | | | |
| LL01 | Laborer-Grp 1 | 8.00 | 2.00 Each (hourly) | U.S. Dollar | | | | |
| EWATER2 | Water Trk-02M Gal (Bare) | 4.00 | 1.00 Each (hourly) | U.S. Dollar | | | | |
| 99.1.1.6 | 1.00 LS | pave day due to loss of production | 1.00 | 1.00 | Detail | U.S. Dollar | 14,796.96 | 14,796.96 |
| 99.1.1.6.2 | 163.00 TN | pave with transfers | 1.00 | 163.00 | Detail | U.S. Dollar | 90.78 | 14,796.96 |
| Resource Code | Description | Hours | Quantity UM | Currency | Unit Cost | Total Cost | | |
| O-OF | OE Foreman w/Trk | 16.00 | 1.00 Hour | U.S. Dollar | | | | |
| OAP10 | Asph Paver-10' Wide | 32.00 | 1.00 Hour | U.S. Dollar | | | | |
| OSKIP | Tractor-Box Scraper | 16.00 | 1.00 Hour | U.S. Dollar | | | | |
| OROLL12 | Roller-12 TN DD, CB-534 | 16.00 | 1.00 Hour | U.S. Dollar | | | | |
| OROLLP12 | Roller-12 TN PT | 16.00 | 1.00 Hour | U.S. Dollar | | | | |
| OROLL8 | Roller-08 TN DD, CB-434 | 16.00 | 1.00 Hour | U.S. Dollar | | | | |
| O-ACR | Asphalt Raker | 16.00 | 2.00 Hour | U.S. Dollar | | | | |
| O-ACS | Asphalt Shoveler | 16.00 | 2.00 Hour | U.S. Dollar | | | | |
| LL01 | Laborer-Grp 1 | 8.00 | 1.00 Each (hourly) | U.S. Dollar | | | | |
| EWATER2 | Water Trk-02M Gal (Bare) | 8.00 | 1.00 Each (hourly) | U.S. Dollar | | | | |

| Cost Item | | | | | | | | |
|-------------------|-------------------|---------------------------|--------------------|-------------|-------------|-------------|------------|------------|
| CBS Position Code | Quantity UM | Description | Days | UM/Day | Cost Source | Currency | Unit Cost | Total Cost |
| 99.1.1.7 | 1.00 EA | concrete sub mobilization | 0.00 | 0.00 | Plug | U.S. Dollar | 1,000.00 | 1,000.00 |
| 99.1.1.8 | 1.00 LS | paving mobilization | 0.00 | 0.00 | Detail | U.S. Dollar | 0.00 | 0.00 |
| 99.1.2 | 1.00 LS | ph2 north side of shirk | 13.94 | 0.07 | Detail | U.S. Dollar | 258,476.09 | 258,476.09 |
| 99.1.2.1 | 1.00 LS | mobilization | 3.44 | 0.29 | Detail | U.S. Dollar | 5,500.00 | 5,500.00 |
| Resource Code | Description | Hours | Quantity UM | Currency | Unit Cost | Total Cost | | |
| RHH55 | Lowbed-55 TN (OP) | 27.50 | 1.00 Each (hourly) | U.S. Dollar | 200.00 | 5,500.00 | | |

46,384.79

| 99.1.2.2 | 1.00 LS | grind ex. ac to subgrade and entire side to subgrade, 1.42 x area | 3.00 | 0.33 | Detail | U.S. Dollar | 69,577.19 | 69,577.19 |
|---------------|--------------------------|---|--------------------|-------------|-----------|-------------|-----------|----------------------|
| 99.1.2.2.1 | 2.00 EA | grinder mob, 2 grinders onsite | 0.00 | 0.00 | Plug | U.S. Dollar | 800.00 | 1,600.00 |
| 99.1.2.2.2 | 3.00 DA | grinder rental | 0.00 | 0.00 | Plug | U.S. Dollar | 5,100.00 | 15,300.00 |
| 99.1.2.2.3 | 3.00 DA | grinder support | 3.00 | 1.00 | Detail | U.S. Dollar | 6,504.06 | 19,512.19 |
| Resource Code | Description | Hours | Quantity UM | Currency | Unit Cost | Total Cost | | |
| O-OF | OE Foreman w/Trk | 48.00 | 1.00 Hour | U.S. Dollar | | | | |
| E140 | Blade-12 Ft., 140G | 24.00 | 1.00 Each (hourly) | U.S. Dollar | | | | |
| OSKIP | Tractor-Box Scraper | 48.00 | 1.00 Hour | U.S. Dollar | | | | |
| OCOMP8 | Cmpctr-08 TN PD, CA-15 | 48.00 | 1.00 Hour | U.S. Dollar | | | | |
| O-GRC | Grade Checker | 24.00 | 1.00 Hour | U.S. Dollar | | | | |
| LL01 | Laborer-Grp 1 | 24.00 | 1.00 Each (hourly) | U.S. Dollar | | | | |
| EWATER2 | Water Trk-02M Gal (Bare) | 24.00 | 1.00 Each (hourly) | U.S. Dollar | | | | |
| 99.1.2.2.4 | 4.00 LD | offhaul grindings, 1.1hr RT, 11bcy/LD | 0.00 | 0.00 | Detail | U.S. Dollar | 247.50 | 990.00 |
| Resource Code | Description | Hours | Quantity UM | Currency | Unit Cost | Total Cost | | |
| UHTDS | Trk-Semi Demo | | 6.00 HR | U.S. Dollar | 165.00 | 990.00 | | |
| 99.1.2.2.5 | 176.00 LD | offhaul dirt, 1.1hr RT, 13bcy/LD, 1.42 x area | 0.00 | 0.00 | Detail | U.S. Dollar | 182.81 | 32,175.00 |
| Resource Code | Description | Hours | Quantity UM | Currency | Unit Cost | Total Cost | | |
| UHTDS | Trk-Semi Demo | | 195.00 HR | U.S. Dollar | 165.00 | 32,175.00 | | |
| 99.1.2.3 | 43,314.00 SF | rip / compact subgrade | 1.00 | 43,314.00 | Detail | U.S. Dollar | 0.12 | 5,297.44 |
| Resource Code | Description | Hours | Quantity UM | Currency | Unit Cost | Total Cost | | |
| O-OF | OE Foreman w/Trk | 16.00 | 1.00 Hour | U.S. Dollar | | | | |
| E140 | Blade-12 Ft., 140G | 8.00 | 1.00 Each (hourly) | U.S. Dollar | | | | |
| OCOMP8 | Cmpctr-08 TN PD, CA-15 | 16.00 | 1.00 Hour | U.S. Dollar | | | | |
| O-GRC | Grade Checker | 8.00 | 1.00 Hour | U.S. Dollar | | | | |
| LL01 | Laborer-Grp 1 | 8.00 | 1.00 Each (hourly) | U.S. Dollar | | | | |
| EWATER2 | Water Trk-02M Gal (Bare) | 8.00 | 1.00 Each (hourly) | U.S. Dollar | | | | |

| Cost Item | | | | | | | | |
|-------------------|---------------------------|--|-------------|---------------|-------------|-------------|-----------|------------|
| CBS Position Code | Quantity UM | Description | Days | UM/Day | Cost Source | Currency | Unit Cost | Total Cost |
| 99.1.2.4 | 43,314.00 SF | finish subgrade | 1.00 | 43,314.00 | Detail | U.S. Dollar | 0.18 | 7,824.06 |
| Resource Code | Description | Hours | Quantity UM | | Currency | | Unit Cost | Total Cost |
| O-OF | OE Foreman w/Trk | 16.00 | 1.00 | Hour | U.S. Dollar | | | |
| E140 | Blade-12 Ft., 140G | 8.00 | 1.00 | Each (hourly) | U.S. Dollar | | | |
| O623 | Scraper-22 CY 623 (442) | 16.00 | 1.00 | Hour | U.S. Dollar | | | |
| OCOMP8 | Cmpctr-08 TN PD, CA-15 | 16.00 | 1.00 | Hour | U.S. Dollar | | | |
| O-GRC | Grade Checker | 8.00 | 1.00 | Hour | U.S. Dollar | | | |
| LL01 | Laborer-Grp 1 | 8.00 | 1.00 | Each (hourly) | U.S. Dollar | | | |
| EWATER2 | Water Trk-02M Gal (Bare) | 8.00 | 1.00 | Each (hourly) | U.S. Dollar | | | |
| 99.1.2.5 | 1.50 DA | misc. slow piece meal grading for concrete at intersection | 1.50 | 1.00 | Detail | U.S. Dollar | 5,109.55 | 7,664.32 |
| Resource Code | Description | Hours | Quantity UM | | Currency | | Unit Cost | Total Cost |
| O-OF | OE Foreman w/Trk | 24.00 | 1.00 | Hour | U.S. Dollar | | | |
| ESKIP | Tractor, Front End Loader | 12.00 | 1.00 | Each (hourly) | U.S. Dollar | | | |
| O950 | Loader-3.5 CY, 950 | 12.00 | 0.50 | Hour | U.S. Dollar | | | |
| OROLL3 | Roller-03 TN DD, CB-224 | 12.00 | 0.50 | Hour | U.S. Dollar | | | |
| O-GRC | Grade Checker | 12.00 | 1.00 | Hour | U.S. Dollar | | | |
| LL01 | Laborer-Grp 1 | 12.00 | 1.00 | Each (hourly) | U.S. Dollar | | | |
| EWATER2 | Water Trk-02M Gal (Bare) | 12.00 | 1.00 | Each (hourly) | U.S. Dollar | | | |
| 99.1.2.6 | 1.00 LS | sawcut so can pour island neat against ac | 0.00 | 0.00 | Plug | U.S. Dollar | 600.00 | 600.00 |
| 99.1.2.7 | 4,833.00 TN | ab | 4.00 | 1,208.25 | Detail | U.S. Dollar | 33.32 | 161,013.08 |
| 99.1.2.7.1 | 4,833.00 TN | buy / haul ab, 17" deep | 0.00 | 0.00 | Detail | U.S. Dollar | 27.63 | 133,549.63 |
| 99.1.2.7.1.1 | 4,833.00 TN | buy ab | 0.00 | 0.00 | Detail | U.S. Dollar | 18.63 | 90,052.63 |
| Resource Code | Description | Hours | Quantity UM | | Currency | | Unit Cost | Total Cost |
| MRB23/4 | Agg Base-3/4" Class 2 | | 4,833.00 | TN | U.S. Dollar | | 17.90 | 86,522.78 |
| ABENVIRO | AB ENVIRO FEE | | 201.71 | LD | U.S. Dollar | | 17.50 | 3,529.85 |
| 99.1.2.7.1.2 | 4,833.00 TN | haul ab | 0.00 | 0.00 | Detail | U.S. Dollar | 9.00 | 43,497.00 |
| Resource Code | Description | Hours | Quantity UM | | Currency | | Unit Cost | Total Cost |
| HAULABBOTT | HAUL AB BOTTOMS | | 4,833.00 | TN | U.S. Dollar | | 9.00 | 43,497.00 |
| 99.1.2.7.2 | 4,833.00 TN | place / compact ab | 3.00 | 1,611.00 | Detail | U.S. Dollar | 4.01 | 19,359.62 |
| Resource Code | Description | Hours | Quantity UM | | Currency | | Unit Cost | Total Cost |
| O-OF | OE Foreman w/Trk | 48.00 | 1.00 | Hour | U.S. Dollar | | | |
| E140 | Blade-12 Ft., 140G | 24.00 | 1.00 | Each (hourly) | U.S. Dollar | | | |
| OROLL12 | Roller-12 TN DD, CB-534 | 48.00 | 1.00 | Hour | U.S. Dollar | | | |
| O-GRC | Grade Checker | 24.00 | 1.00 | Hour | U.S. Dollar | | | |
| LL01 | Laborer-Grp 1 | 48.00 | 2.00 | Each (hourly) | U.S. Dollar | | | |
| EWATER2 | Water Trk-02M Gal (Bare) | 24.00 | 1.00 | Each (hourly) | U.S. Dollar | | | |
| 99.1.2.7.3 | 43,314.00 SF | finish ab | 1.00 | 43,314.00 | Detail | U.S. Dollar | 0.19 | 8,103.83 |
| Resource Code | Description | Hours | Quantity UM | | Currency | | Unit Cost | Total Cost |
| O-OF | OE Foreman w/Trk | 16.00 | 1.00 | Hour | U.S. Dollar | | | |
| E140 | Blade-12 Ft., 140G | 8.00 | 1.00 | Each (hourly) | U.S. Dollar | | | |

| Cost Item | | | | | | | | | |
|---------------------|-------------------------|---------------|--------------------------------------|-----------------|-----------------|-----------------|------------------------|---------------------|---------------------|
| CBS Position Code | Quantity | UM | Description | Days | UM/Day | Cost Source | Currency | Unit Cost | Total Cost |
| O950 | | | Loader-3.5 CY, 950 | 16.00 | 1.00 | Hour | U.S. Dollar | | |
| OROLL12 | | | Roller-12 TN DD, CB-534 | 16.00 | 1.00 | Hour | U.S. Dollar | | |
| O-GRC | | | Grade Checker | 8.00 | 1.00 | Hour | U.S. Dollar | | |
| LL01 | | | Laborer-Grp 1 | 16.00 | 2.00 | Each (hourly) | U.S. Dollar | | |
| EWATER2 | | | Water Trk-02M Gal (Bare) | 8.00 | 1.00 | Each (hourly) | U.S. Dollar | | |
| 99.1.2.9 | 1.00 | EA | concrete sub mobilization | 0.00 | 0.00 | Plug | U.S. Dollar | 1,000.00 | 1,000.00 |
| 0.2 | 1.00 | LS | Prime Bond | 0.00 | 0.00 | Detail | U.S. Dollar | | 0.00 |
| 0.3 | 1.00 | LS | Price % Add-On | 0.00 | 0.00 | Detail | U.S. Dollar | | 0.00 |
| 0.4 | 1.00 | LS | Job Financing | 0.00 | 0.00 | Plug | U.S. Dollar | | 0.00 |
| 0.5 | 1.00 | LS | Indirect Cost Escalation | 0.00 | 0.00 | Detail | U.S. Dollar | | 0.00 |
| 0.6 | 1.00 | LS | Direct Cost Escalation | 0.00 | 0.00 | Detail | U.S. Dollar | | 6,501.46 |
| 0.7 | 1.00 | LS | Indirect Cost Add-On | 0.00 | 0.00 | Detail | U.S. Dollar | | 0.00 |
| 0.8 | 1.00 | LS | Job Management & Equipment | 0.00 | 0.00 | Detail | U.S. Dollar | | 0.00 |
| Resource Code | Description | Hours | Quantity | UM | Currency | Unit Cost | Total Cost | | |
| M&E | Meals and Entertainment | | 1.00 | LS | U.S. Dollar | 0.00 | 0.00 | | |
| 0.9 | General Expense | | 0.00 | 0.00 | Detail | U.S. Dollar | 0.00 | | |
| 0.10 | Direct Cost Add-On | | 0.00 | 0.00 | Detail | U.S. Dollar | 0.00 | | |
| Report Total: | | | 17.44 | | | | | | 318,121.81 |

| Category | Total |
|------------------|------------|
| Labor | 68,819.06 |
| Owned Equipment | 37,306.78 |
| Rented Equipment | 25,350.00 |
| Materials | 136,829.42 |
| Subcontract | 2,000.00 |
| Fees | 7,486.55 |
| Trucking | 40,330.00 |

Estimate Summary

AGEE CONSTRUCTION CORPORATION

Job Code: J25-05 PCO

Description: Riggan Ave. Widening from Kelsey to Shirk, City of Visalia

From Cost Item: 0.2

To Cost Item: 101.1.4.3

| Cost Item | | | | | | | | |
|-------------------|--------------------------|--|--------------------|-------------|-------------|-------------|-----------|------------|
| CBS Position Code | Quantity UM | Description | Days | UM/Day | Cost Source | Currency | Unit Cost | Total Cost |
| 101 | 1.00 LS | AB Section in Lieu of FDR | 5.00 | 0.20 | Detail | U.S. Dollar | 76,936.24 | 76,936.24 |
| 101.1 | 1.00 LS | AB Add in Lieu of FDR | 5.00 | 0.20 | Detail | U.S. Dollar | 76,936.24 | 76,936.24 |
| 101.1.1 | 345.00 CY | remove ex. dirt to subgrade | 1.00 | 345.00 | Detail | U.S. Dollar | 59.07 | 20,379.06 |
| 101.1.1.1 | 1.00 EA | 4' grinder mob | 0.00 | 0.00 | Plug | U.S. Dollar | 800.00 | 800.00 |
| 101.1.1.2 | 1.00 DA | 4' grinder rental | 0.00 | 0.00 | Plug | U.S. Dollar | 4,000.00 | 4,000.00 |
| 101.1.1.3 | 1.00 DA | grinder support | 1.00 | 1.00 | Detail | U.S. Dollar | 6,504.06 | 6,504.06 |
| Resource Code | Description | Hours | Quantity UM | Currency | Unit Cost | Total Cost | | |
| O-OF | OE Foreman w/Trk | 16.00 | 1.00 Hour | U.S. Dollar | | | | |
| E140 | Blade-12 Ft., 140G | 8.00 | 1.00 Each (hourly) | U.S. Dollar | | | | |
| OSKIP | Tractor-Box Scraper | 16.00 | 1.00 Hour | U.S. Dollar | | | | |
| OCOMP8 | Cmpctr-08 TN PD, CA-15 | 16.00 | 1.00 Hour | U.S. Dollar | | | | |
| O-GRC | Grade Checker | 8.00 | 1.00 Hour | U.S. Dollar | | | | |
| LL01 | Laborer-Grp 1 | 8.00 | 1.00 Each (hourly) | U.S. Dollar | | | | |
| EWATER2 | Water Trk-02M Gal (Bare) | 8.00 | 1.00 Each (hourly) | U.S. Dollar | | | | |
| 101.1.1.4 | 50.00 LD | offhaul dirt, 1.1hr RT, 13bcy/LD | 0.00 | 0.00 | Detail | U.S. Dollar | 181.50 | 9,075.00 |
| Resource Code | Description | Hours | Quantity UM | Currency | Unit Cost | Total Cost | | |
| UHTDS | Trk-Semi Demo | | 55.00 HR | U.S. Dollar | 165.00 | 9,075.00 | | |
| 101.1.2 | 13,886.00 SF | rip / compact subgrade, loss of production day | 0.50 | 27,772.00 | Detail | U.S. Dollar | 0.19 | 2,648.72 |
| Resource Code | Description | Hours | Quantity UM | Currency | Unit Cost | Total Cost | | |
| O-OF | OE Foreman w/Trk | 8.00 | 1.00 Hour | U.S. Dollar | | | | |
| E140 | Blade-12 Ft., 140G | 4.00 | 1.00 Each (hourly) | U.S. Dollar | | | | |
| OCOMP8 | Cmpctr-08 TN PD, CA-15 | 8.00 | 1.00 Hour | U.S. Dollar | | | | |
| O-GRC | Grade Checker | 4.00 | 1.00 Hour | U.S. Dollar | | | | |
| LL01 | Laborer-Grp 1 | 4.00 | 1.00 Each (hourly) | U.S. Dollar | | | | |
| EWATER2 | Water Trk-02M Gal (Bare) | 4.00 | 1.00 Each (hourly) | U.S. Dollar | | | | |
| 101.1.3 | 13,886.00 SF | finish subgrade | 1.00 | 13,886.00 | Detail | U.S. Dollar | 0.50 | 6,948.06 |
| Resource Code | Description | Hours | Quantity UM | Currency | Unit Cost | Total Cost | | |
| O-OF | OE Foreman w/Trk | 16.00 | 1.00 Hour | U.S. Dollar | | | | |
| E140 | Blade-12 Ft., 140G | 8.00 | 1.00 Each (hourly) | U.S. Dollar | | | | |
| O950 | Loader-3.5 CY, 950 | 16.00 | 1.00 Hour | U.S. Dollar | | | | |
| OCOMP8 | Cmpctr-08 TN PD, CA-15 | 16.00 | 1.00 Hour | U.S. Dollar | | | | |
| O-GRC | Grade Checker | 8.00 | 1.00 Hour | U.S. Dollar | | | | |
| LL01 | Laborer-Grp 1 | 8.00 | 1.00 Each (hourly) | U.S. Dollar | | | | |
| EWATER2 | Water Trk-02M Gal (Bare) | 8.00 | 1.00 Each (hourly) | U.S. Dollar | | | | |
| 101.1.4 | 1,215.00 TN | ab | 2.50 | 486.00 | Detail | U.S. Dollar | 38.65 | 46,960.40 |
| 101.1.4.1 | 1,215.00 TN | buy / haul ab, 15.4" deep | 0.00 | 0.00 | Detail | U.S. Dollar | 25.95 | 31,534.04 |

| Cost Item | | | | | | | | |
|-------------------|--------------------------|----------------------------|--------------------|-------------|-------------|-------------|-----------|------------|
| CBS Position Code | Quantity UM | Description | Days | UM/Day | Cost Source | Currency | Unit Cost | Total Cost |
| 101.1.4.1.1 | 1,215.00 TN | buy ab | 0.00 | 0.00 | Detail | U.S. Dollar | 18.95 | 23,029.04 |
| Resource Code | Description | Hours | Quantity UM | Currency | Unit Cost | Total Cost | | |
| MRB23/4 | Agg Base-3/4" Class 2 | | 1,215.00 TN | U.S. Dollar | 17.90 | 21,751.54 | | |
| ABENVIRO | AB ENVIRO FEE | | 73.00 LD | U.S. Dollar | 17.50 | 1,277.50 | | |
| 101.1.4.1.2 | 1,215.00 TN | haul ab | 0.00 | 0.00 | Detail | U.S. Dollar | 7.00 | 8,505.00 |
| Resource Code | Description | Hours | Quantity UM | Currency | Unit Cost | Total Cost | | |
| HAULABTRAN | HAUL AB TRANSFER | | 1,215.00 TN | U.S. Dollar | 7.00 | 8,505.00 | | |
| 101.1.4.2 | 1,215.00 TN | place / compact ab | 1.50 | 810.00 | Detail | U.S. Dollar | 7.97 | 9,679.81 |
| Resource Code | Description | Hours | Quantity UM | Currency | Unit Cost | Total Cost | | |
| O-OF | OE Foreman w/Trk | 24.00 | 1.00 Hour | U.S. Dollar | | | | |
| E140 | Blade-12 Ft., 140G | 12.00 | 1.00 Each (hourly) | U.S. Dollar | | | | |
| OROLL12 | Roller-12 TN DD, CB-534 | 24.00 | 1.00 Hour | U.S. Dollar | | | | |
| O-GRC | Grade Checker | 12.00 | 1.00 Hour | U.S. Dollar | | | | |
| LL01 | Laborer-Grp 1 | 24.00 | 2.00 Each (hourly) | U.S. Dollar | | | | |
| EWATER2 | Water Trk-02M Gal (Bare) | 12.00 | 1.00 Each (hourly) | U.S. Dollar | | | | |
| 101.1.4.3 | 13,889.00 SF | finish ab | 1.00 | 13,889.00 | Detail | U.S. Dollar | 0.41 | 5,746.55 |
| Resource Code | Description | Hours | Quantity UM | Currency | Unit Cost | Total Cost | | |
| O-OF | OE Foreman w/Trk | 16.00 | 1.00 Hour | U.S. Dollar | | | | |
| E140 | Blade-12 Ft., 140G | 8.00 | 1.00 Each (hourly) | U.S. Dollar | | | | |
| O950 | Loader-3.5 CY, 950 | 8.00 | 0.50 Hour | U.S. Dollar | | | | |
| OROLL12 | Roller-12 TN DD, CB-534 | 8.00 | 0.50 Hour | U.S. Dollar | | | | |
| O-GRC | Grade Checker | 8.00 | 1.00 Hour | U.S. Dollar | | | | |
| LL01 | Laborer-Grp 1 | 8.00 | 1.00 Each (hourly) | U.S. Dollar | | | | |
| EWATER2 | Water Trk-02M Gal (Bare) | 8.00 | 1.00 Each (hourly) | U.S. Dollar | | | | |
| 0.2 | 1.00 LS | Prime Bond | 0.00 | 0.00 | Detail | U.S. Dollar | | 0.00 |
| 0.3 | 1.00 LS | Price % Add-On | 0.00 | 0.00 | Detail | U.S. Dollar | | 0.00 |
| 0.4 | 1.00 LS | Job Financing | 0.00 | 0.00 | Plug | U.S. Dollar | | 0.00 |
| 0.5 | 1.00 LS | Indirect Cost Escalation | 0.00 | 0.00 | Detail | U.S. Dollar | | 0.00 |
| 0.6 | 1.00 LS | Direct Cost Escalation | 0.00 | 0.00 | Detail | U.S. Dollar | | 0.00 |
| 0.7 | 1.00 LS | Indirect Cost Add-On | 0.00 | 0.00 | Detail | U.S. Dollar | | 0.00 |
| 0.8 | 1.00 LS | Job Management & Equipment | 0.25 | 4.00 | Detail | U.S. Dollar | | 327.70 |
| Resource Code | Description | Hours | Quantity UM | Currency | Unit Cost | Total Cost | | |
| M&E | Meals and Entertainment | | 1.00 LS | U.S. Dollar | 0.00 | 0.00 | | |
| LO02 | Operating Engr.-Grp 2 | 2.00 | 1.00 Each (hourly) | U.S. Dollar | | | | |
| ETRK1 | Trk-1 Ton Pickup | 2.00 | 1.00 Each (hourly) | U.S. Dollar | | | | |
| 0.9 | 1.00 LS | General Expense | 0.00 | 0.00 | Detail | U.S. Dollar | | 0.00 |
| 0.10 | 1.00 LS | Direct Cost Add-On | 0.00 | 0.00 | Detail | U.S. Dollar | | 0.00 |
| Report Total: | | | 5.25 | | | | | 77,263.94 |

| Cost Item | | | | | | | | | |
|----------------------|----------|----|-------------|------|--------|----------------|--------------|-----------|------------|
| CBS Position Code | Quantity | UM | Description | Days | UM/Day | Cost Source | Currency | Unit Cost | Total Cost |
| Category | | | | | | | Total | | |
| Labor | | | | | | | | | 19,801.08 |
| Owned Equipment | | | | | | | | | 12,053.82 |
| Rented Equipment | | | | | | | | | 4,800.00 |
| Materials | | | | | | | | | 21,325.00 |
| Fees | | | | | | | | | 1,704.04 |
| Trucking | | | | | | | | | 17,580.00 |

$$\boxed{\$76,936.24 \times 1.2 = 92,323}$$



Know what's below. Call before you dig.

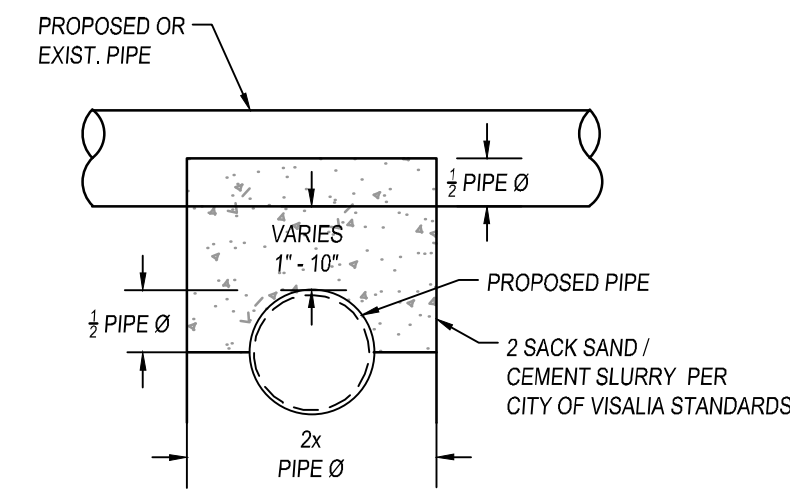
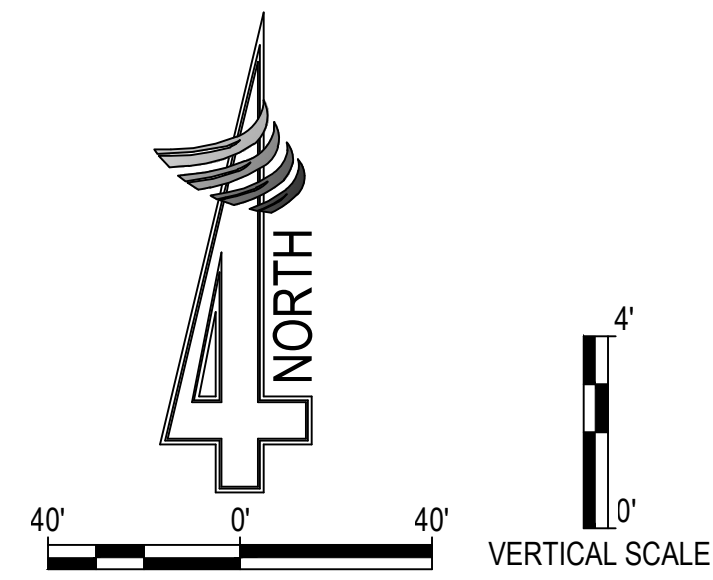
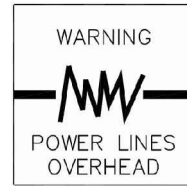

DETAIL A

GENERAL CONSTRUCTION NOTES (SHEETS 11-17 ONLY)

- 1. ALL SAWCUTS TO BE A NEAT, CLEAN, ON GRADE EDGE.
- 2. ALL NEW CONCRETE IMPROVEMENTS SHALL BE DOWELED INTO EXIST. CONCRETE IMPROVEMENTS PER CITY STD. C-34.

CONSTRUCTION KEYNOTES (SHEETS 11-17 ONLY)

- 1. INSTALL CONCRETE COLD JOINT PER CITY STD. C-34.
- 2. INSTALL CONCRETE CURB AND GUTTER PER CITY STD. C-4.
- 3. INSTALL TYPE 'W' ASPHALT DIKE PER CALTRANS STD. A67B.
- 4. INSTALL MEDIAN CURB PER CITY STD. C-8.
- 5. INSTALL DRAINAGE INLET PER CITY STD. D-12.
- 6. INSTALL 48" STORM DRAIN MANHOLE PER CITY STD. D-1.
- 7. INSTALL 48" SANITARY SEWER MANHOLE PER CITY STD. S-1.
- 8. TIE-INTO EXIST. MANHOLE.
- 9. INSTALL FIRE HYDRANT PER CALWATER PLANS.
- 10. INSTALL 72" SANITARY SEWER MANHOLE PER CITY STD. S-3.
- 11. CONTRACTOR TO CONCRETE SLURRY BETWEEN PIPES PER DETAIL A, THIS SHEET.

LEGEND (SHEETS 11-17 ONLY)

- DETAIL REFERENCE
- EXIST. ASPHALT CONCRETE
- EXIST. CONCRETE
- PROPOSED CONCRETE
- PROPOSED ASPHALT CONCRETE (SEE CROSS SECTIONS)
- PROPOSED ASPHALT BIKE PATH (SEE CROSS SECTIONS)
- STAMPED CONCRETE MEDIAN (CITY STD. C-35)
- DETECTABLE WARNING SURFACE
- GRADE BREAK/CROWN
- SWALE

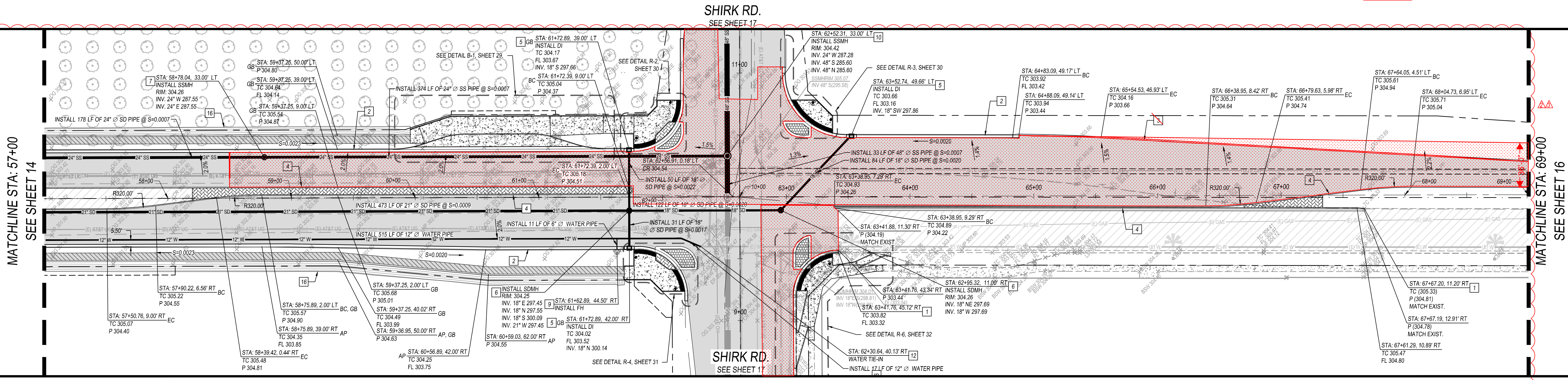

RIGGINS AVE. STA: 57+00 - STA: 69+00

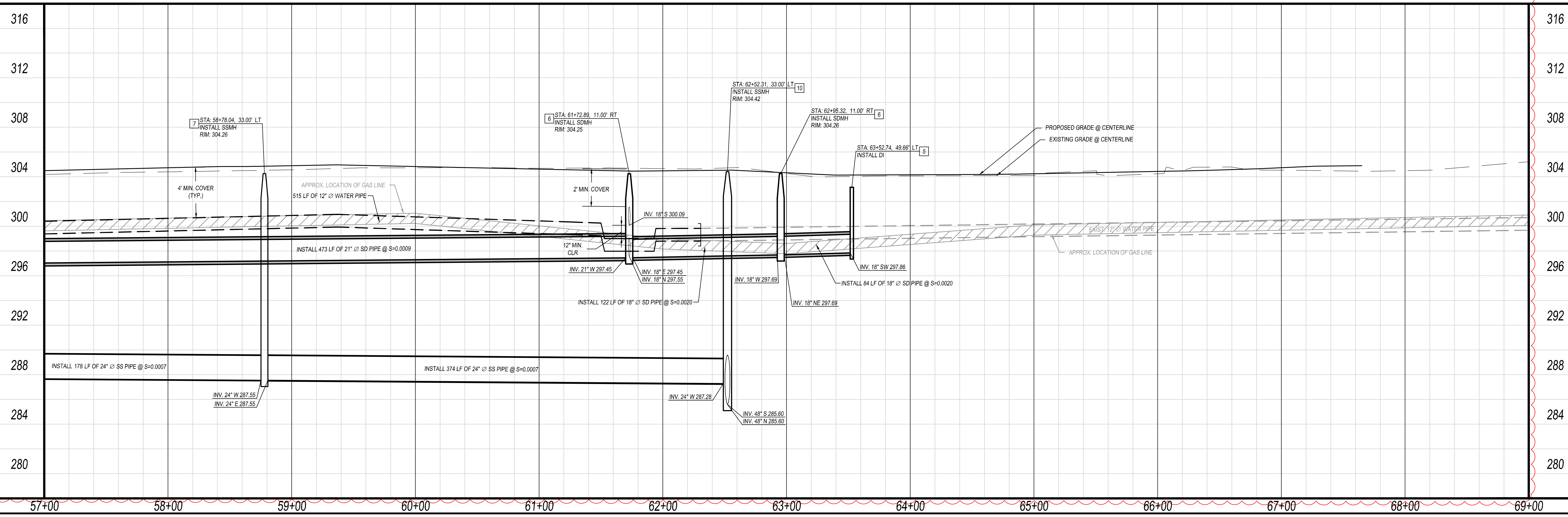

| NO. | DATE | DESCRIPTION |
|-----|-----------|-----------------------|
| 1 | 2.21.2025 | BD ADDENDUM #1 |
| 2 | 4.11.2025 | CONFORMED PLANS |
| 3 | 9.24.2025 | STORM DRAIN REVISIONS |

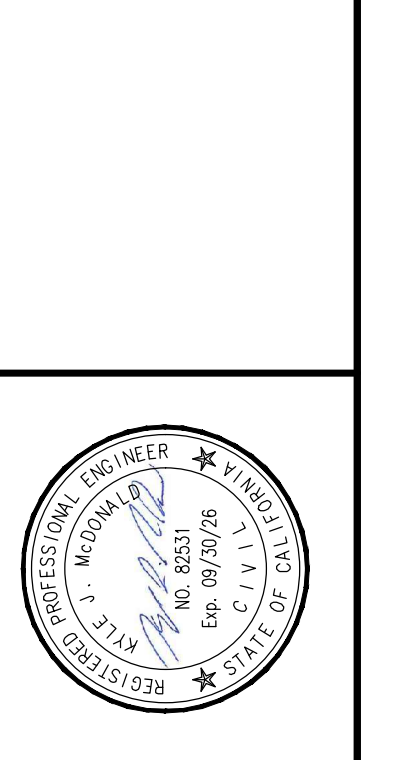

324 S. SANTA FE, STE. A
 P.O. BOX 7588
 VISALIA, CA 93282
 TEL: 559.262.1100
 FAX: 559.902.2615



CITY OF VISALIA
 315 E. ACEQUIA AVE.
 VISALIA, CA 93291

**RIGGINS AVENUE
 WIDENING & IMPROVEMENTS
 IMPROVEMENT PLAN & PROFILE**

PROJ. NO. 20205
 DATE: 12/06/2024
 DESIGN BY: KM DRAWN BY: MH
 SCALE: AS SHOWN
 SHEET 15 OF 63



Know what's below.
Call before you dig.

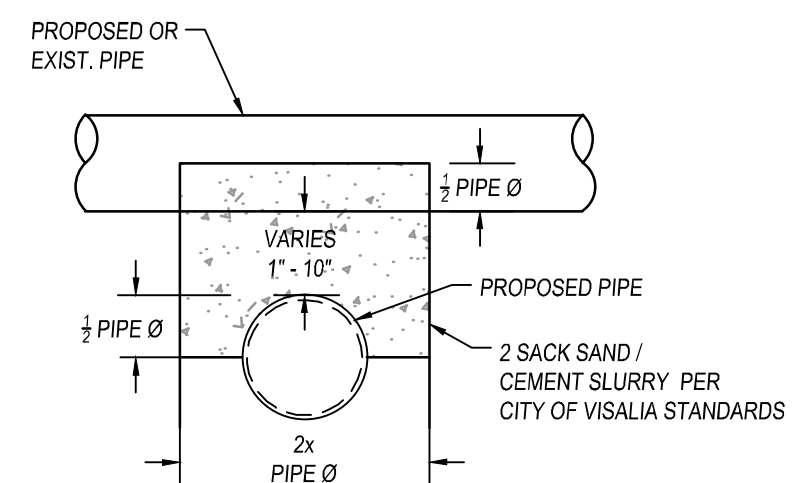
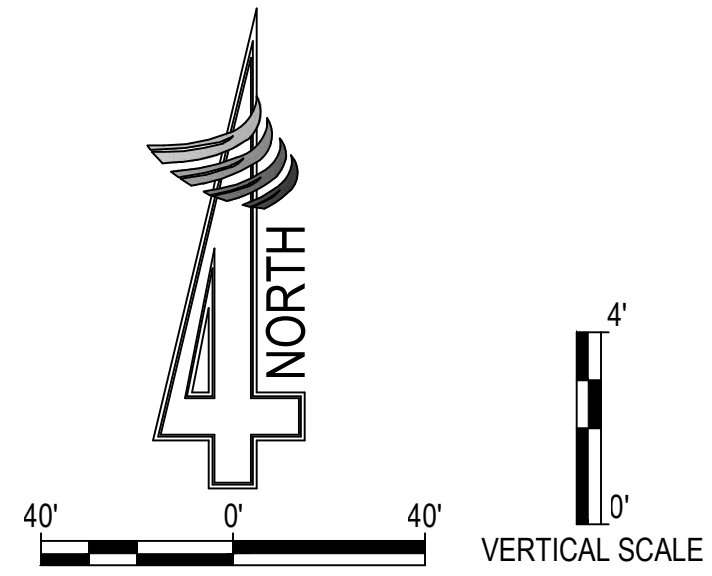
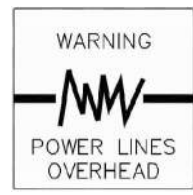

DETAIL A

GENERAL CONSTRUCTION NOTES (SHEETS 11-17 ONLY)

- 1. ALL SAWCUTS TO BE A NEAT, CLEAN, ON GRADE EDGE.
- 2. ALL NEW CONCRETE IMPROVEMENTS SHALL BE DOWELED INTO EXIST. CONCRETE IMPROVEMENTS PER CITY STD. C-34.

CONSTRUCTION KEYNOTES (SHEETS 11-17 ONLY)

- 1. INSTALL CONCRETE COLD JOINT PER CITY STD. C-34.
- 2. INSTALL CONCRETE CURB AND GUTTER PER CITY STD. C-4.
- 3. INSTALL TYPE 'X' ASPHALT DIKE PER CALTRANS STD. A67B.
- 4. INSTALL MEDIAN CURB PER CITY STD. C-8.
- 5. INSTALL DRAINAGE INLET PER CITY STD. D-12.
- 6. INSTALL 48" STORM DRAIN MANHOLE PER CITY STD. D-1.
- 7. INSTALL 48" SANITARY SEWER MANHOLE PER CITY STD. S-1.
- 8. TIE-INTO EXIST. MANHOLE.
- 9. INSTALL FIRE HYDRANT PER CALWATER PLANS.
- 10. INSTALL 72" SANITARY SEWER MANHOLE PER CITY STD. S-3.
- 11. CONTRACTOR TO CONCRETE SLURRY BETWEEN PIPES PER DETAIL 'A' THIS SHEET.

LEGEND (SHEETS 11-17 ONLY)

- DETAIL REFERENCE
- EXIST. ASPHALT CONCRETE
- EXIST. CONCRETE
- PROPOSED CONCRETE
- PROPOSED ASPHALT CONCRETE (SEE CROSS SECTIONS)
- PROPOSED ASPHALT BIKE PATH (SEE CROSS SECTIONS)
- STAMPED CONCRETE MEDIAN (CITY STD. C-35)
- DETECTABLE WARNING SURFACE
- GRADE BREAK/CROWN
- SWALE

Additional Paving:
7" AC / 17" AB

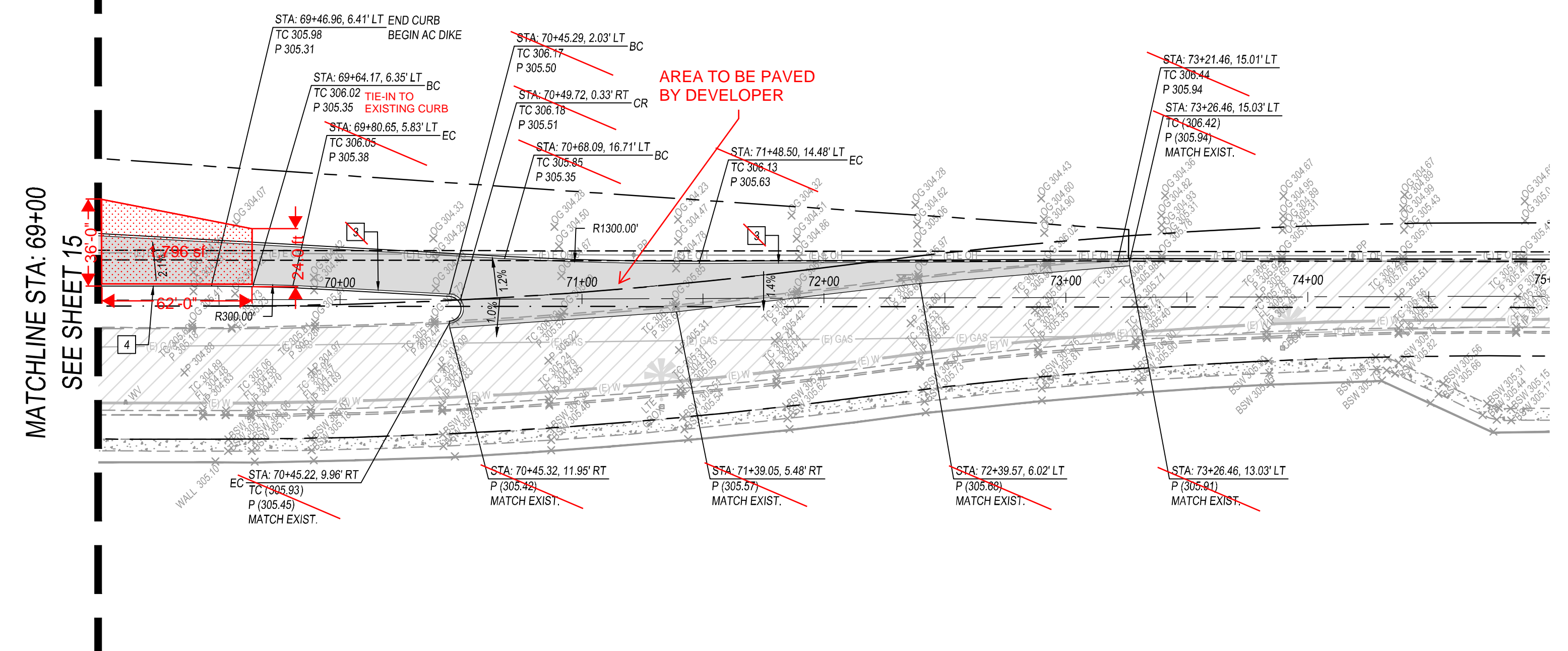

RIGGIN AVE. STA: 69+00 - END

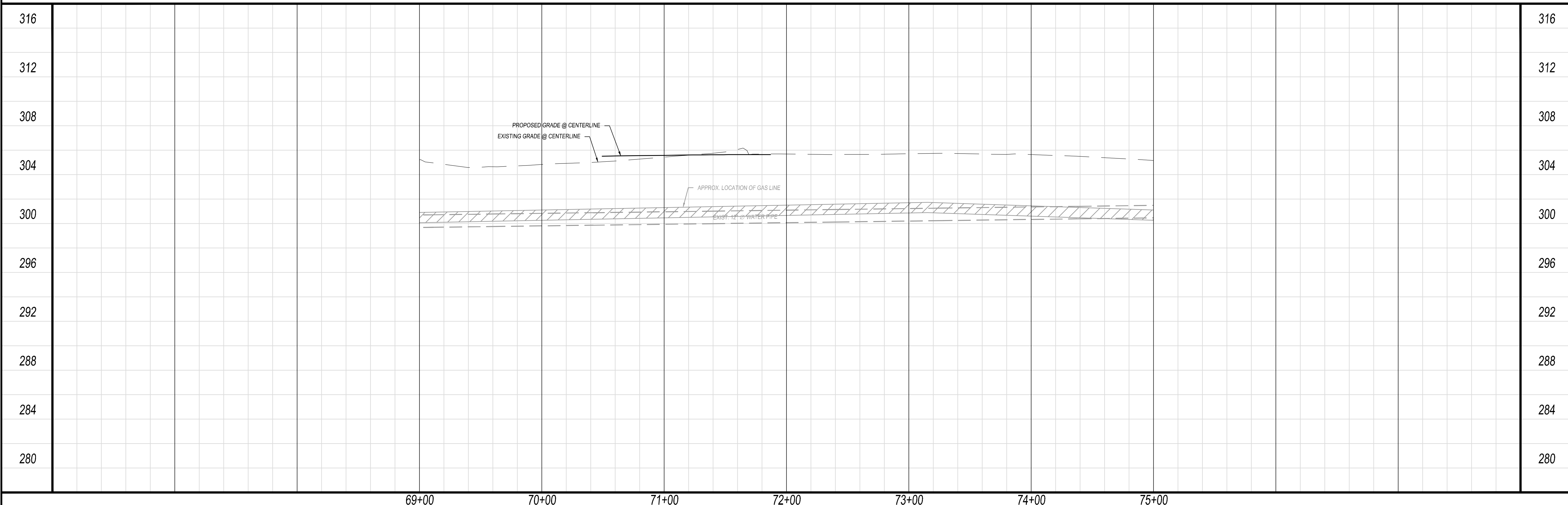

| NO. | DATE | DESCRIPTION |
|-----------|-----------|-----------------|
| 2.21.2025 | 4.11.2025 | CONFORMED PLANS |

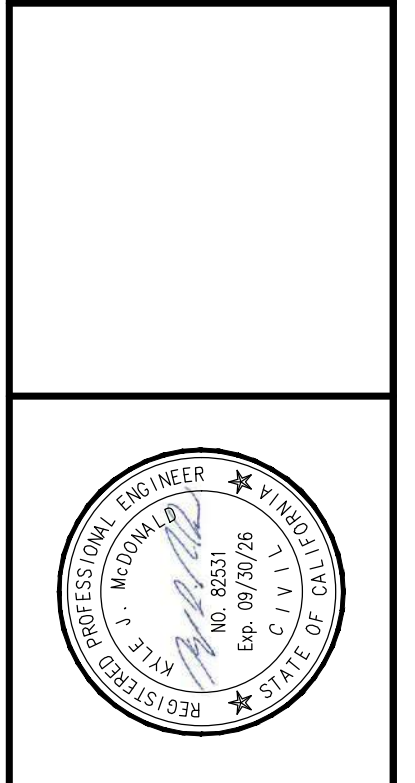

324 S. SANTA FE, STE. A
P.O. BOX 7582
SANTA FE, NM 87502
TEL: 505.825.1111
FAX: 505.825.1111

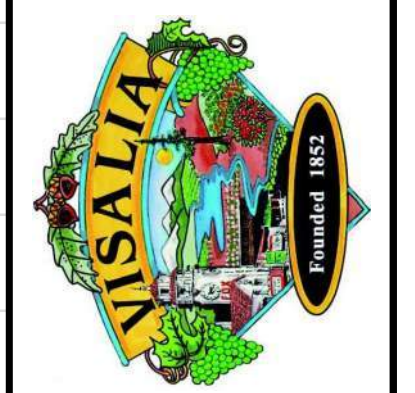

CITY OF VISALIA
315 E. ACEQUIA AVE.
VISALIA, CA 93291

RIGGIN AVENUE
WIDENING & IMPROVEMENTS
IMPROVEMENT PLAN & PROFILE

PROJ. NO. 20205
DATE: 12/06/2024
DESIGN BY: KM DRAWN BY: MH
SCALE: AS SHOWN
SHEET 16 OF 63



Know what's below. Call before you dig.

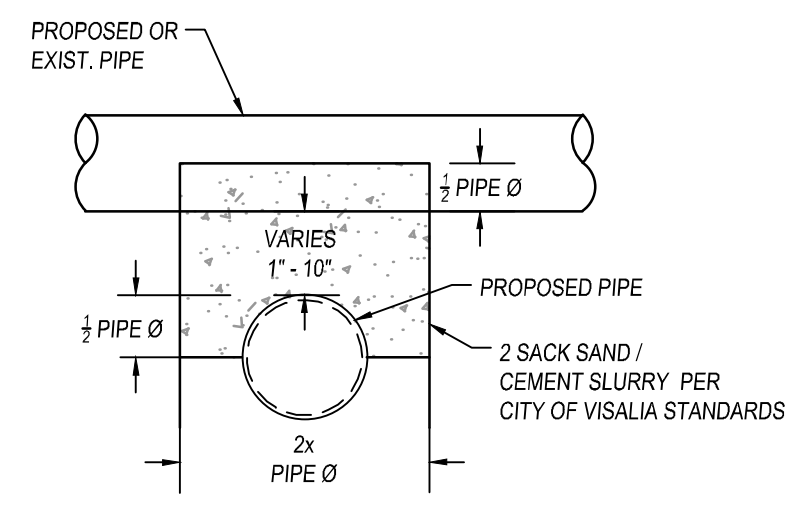
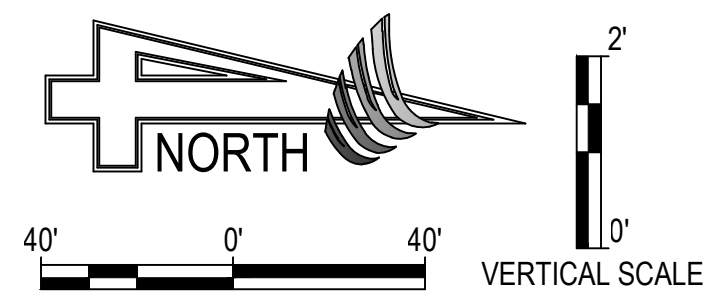
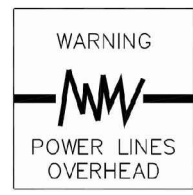

DETAIL A

GENERAL CONSTRUCTION NOTES (SHEETS 11-17 ONLY)

- 1. ALL SAWCUTS TO BE A NEAT, CLEAN, ON GRADE EDGE.
- 2. ALL NEW CONCRETE IMPROVEMENTS SHALL BE DOWELED INTO EXIST. CONCRETE IMPROVEMENTS PER CITY STD. C-34.

CONSTRUCTION KEYNOTES (SHEETS 11-17 ONLY)

- 1. INSTALL CONCRETE COLD JOINT PER CITY STD. C-34.
- 2. INSTALL CONCRETE CURB AND GUTTER PER CITY STD. C-4.
- 3. INSTALL TYPE 'W' ASPHALT DIKE PER CALTRANS STD. A67B.
- 4. INSTALL MEDIAN CURB PER CITY STD. C-8.
- 5. INSTALL DRAINAGE INLET PER CITY STD. D-12.
- 6. INSTALL 48" STORM DRAIN MANHOLE PER CITY STD. D-1.
- 7. INSTALL 48" SANITARY SEWER MANHOLE PER CITY STD. S-1.
- 8. TIE-INTO EXIST. MANHOLE.
- 9. INSTALL FIRE HYDRANT PER CALWATER PLANS.
- 10. INSTALL 72" SANITARY SEWER MANHOLE PER CITY STD. S-3.
- 11. CONTRACTOR TO CONCRETE SLURRY BETWEEN PIPES PER DETAIL A, THIS SHEET.

LEGEND (SHEETS 11-17 ONLY)

- DETAIL REFERENCE
- EXIST. ASPHALT CONCRETE
- EXIST. CONCRETE
- PROPOSED CONCRETE
- PROPOSED ASPHALT CONCRETE (SEE CROSS SECTIONS)
- PROPOSED ASPHALT BIKE PATH (SEE CROSS SECTIONS)
- STAMPED CONCRETE MEDIAN (CITY STD. C-35)
- DETECTABLE WARNING SURFACE
- GRADE BREAK/CROWN
- SWALE

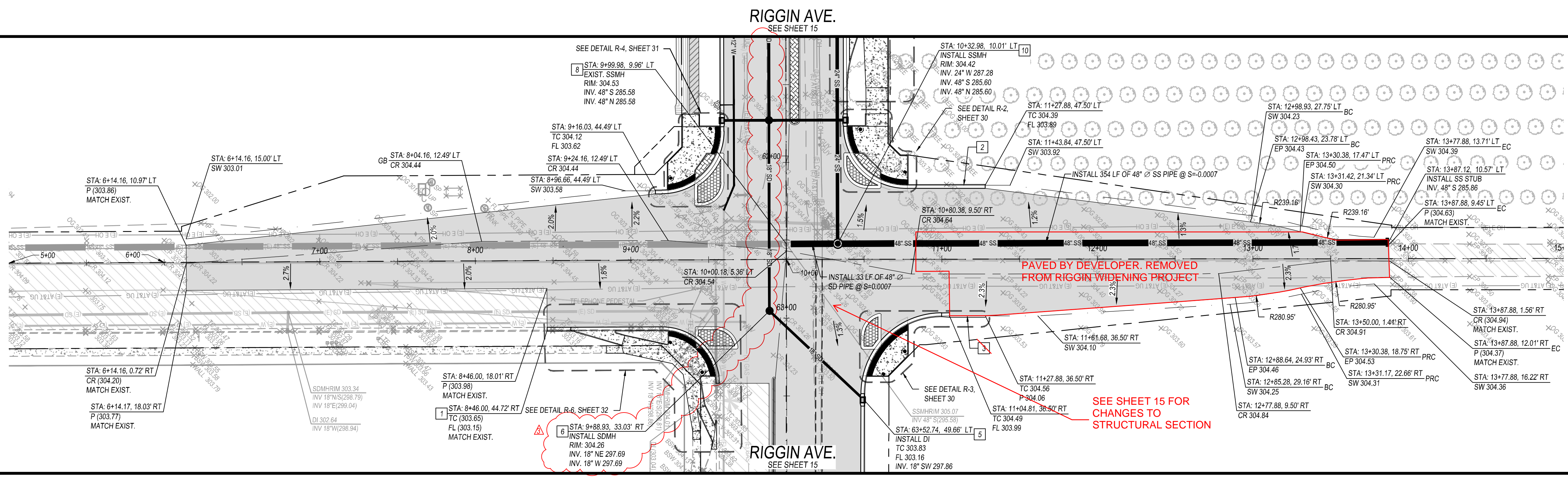

SHIRK RD. STA: 5+00 - END

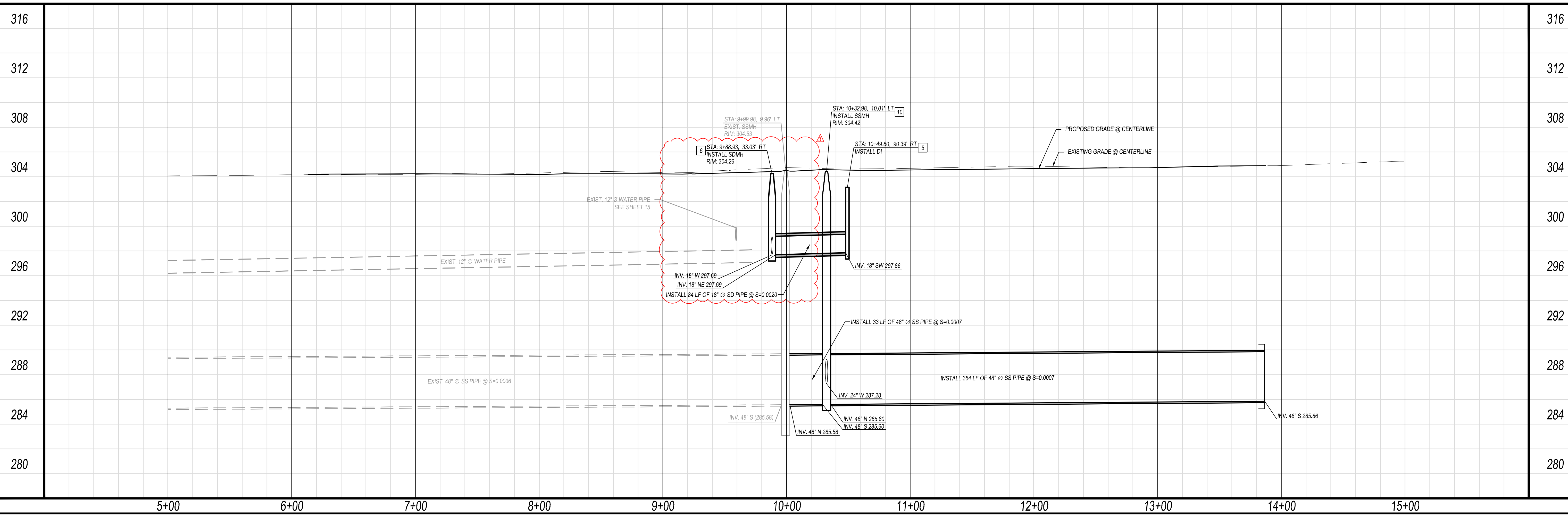

| NO. | DATE | DESCRIPTION |
|-----------|------|-----------------------|
| 2.21.2025 | | RD ADDENDUM #1 |
| 4.11.2025 | | CONFORMED PLANS |
| 9.24.2025 | | STORM DRAIN REVISIONS |

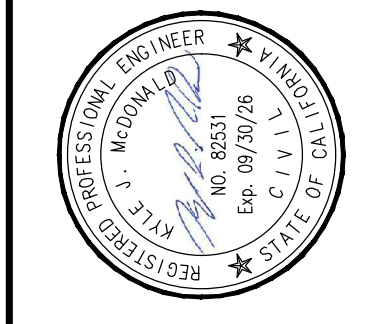

324 S. SANTA FE, STE. A
 P.O. BOX 7588
 VISALIA, CA 93282
 TEL: 559.232.5822
 FAX: 559.902.2670

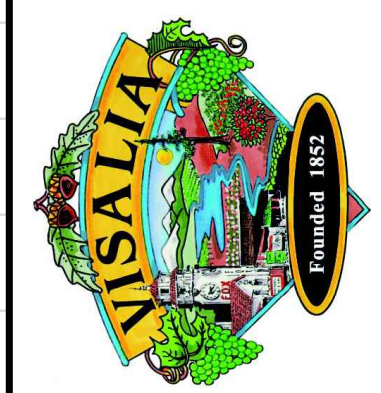

CITY OF VISALIA
 315 E. ACEQUIA AVE.
 VISALIA, CA 93291

**RIGGIN AVENUE
 WIDENING & IMPROVEMENTS
 IMPROVEMENT PLAN & PROFILE**

PROJ. NO. 20205
 DATE: 12/06/2024
 DESIGN BY: KM DRAWN BY: MH
 SCALE: AS SHOWN
 SHEET 17 OF 63