

LEGEND & KEYNOTES (APPLIES TO SHEETS 42 TO 51)

- ⬠ XX LF PAVEMENT DELINEATION DETAIL & LENGTH (FEET) TO BE INSTALLED PER STATE STD. PLANS
- ① INSTALL 12" CROSSWALK STRIPING (WHITE, UNLESS NOTED OTHERWISE ON PLANS)
- ② INSTALL 12" LIMIT LINE STRIPING (WHITE, UNLESS NOTED OTHERWISE ON PLANS)
- STOP INSTALL "STOP" PAVEMENT MARKING PER STATE STD. PLAN A24D.
- LANE INSTALL "LANE" PAVEMENT MARKING PER STATE STD. PLAN A24D.
- BKE INSTALL "BIKE" PAVEMENT MARKING PER STATE STD. PLAN A24D
- HORIZONTAL DELINEATORS

- ↑ INSTALL BIKE LANE ARROW PAVEMENT MARKING PER REVISED STATE STD. PLAN RSP A24A
- ↪ INSTALL TYPE IV ARROW PAVEMENT MARKING PER REVISED STATE STD. PLAN RSP A24A
- ↪ INSTALL TYPE VI ARROW PAVEMENT MARKING PER REVISED STATE STD. PLAN RSP A24A
- T INSTALL PARKING SPACE PAVEMENT MARKING PER CA MUTCD 2014 FIGURE 3B-21
- FURNISH & INSTALL SIGN AND POST AT THIS LOCATION

ROADWAY STRIPING SYMBOL LIST		
STRIPE	DETAIL NUMBER	DESCRIPTION
⬠	9	7' DASHED WHITE WITH RPM
⬠	22	DOUBLE SOLID YELLOW WITH RPM
⬠	27B	4" SOLID WHITE (RIGHT EDGE LINE)
⬠	29	MEDIAN ISLAND WITH RPM
⬠	31	TWO-WAY LEFT-TURN (YELLOW)
⬠	38	8" CHANNELIZING WITH RPM
①	-	12" CROSSWALK
②	-	12" LIMIT LINE

- NOTES:
- ALL EXIST PAVEMENT DELINEATION IN CONFLICT WITH PROPOSED PAVEMENT DELINEATION SHALL BE REMOVED BY WET SANDBLASTING OR OTHER APPROVED METHODS WHICH WILL CAUSE THE LEAST POSSIBLE DAMAGE TO THE PAVEMENT.
 - ALL STRIPING WORK SHALL BE DONE IN ACCORDANCE WITH THE LATEST EDITIONS OF THE STATE OF CALIFORNIA DEPARTMENT OF TRANSPORTATION STANDARD PLANS AND SPECIFICATIONS, THE 2014 CALIFORNIA MANUAL ON UNIFORM TRAFFIC CONTROL DEVICES (2014 CALIFORNIA MUTCD), UNLESS OTHERWISE DIRECTED BY THE CITY ENGINEER.
 - ALL PAVEMENT MARKINGS, CROSSWALKS, LIMIT LINES, TRAFFIC STRIPES SHALL BE PAINT (2 COATS) UNLESS OTHERWISE DIRECTED BY THE CITY.
 - THE CONTRACTOR IS RESPONSIBLE TO RECORD AND DOCUMENT AS NECESSARY EXISTING STRIPING, PAVEMENT MARKERS AND MARKINGS, BLUE DOT MARKERS FOR FIRE HYDRANTS IN ORDER TO REPLACE THE STRIPING, PAVEMENT MARKERS AND MARKINGS IN KIND.
 - THE PLANS ARE ACCURATE FOR STRIPING ONLY.

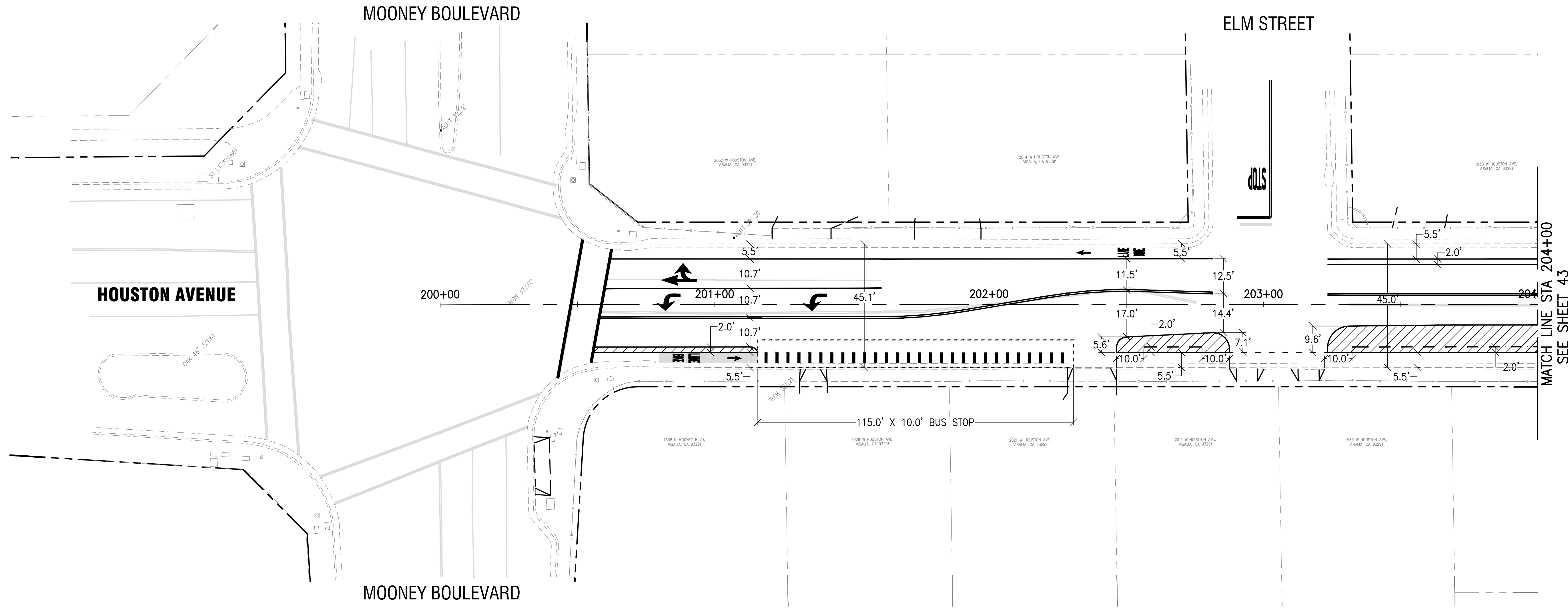
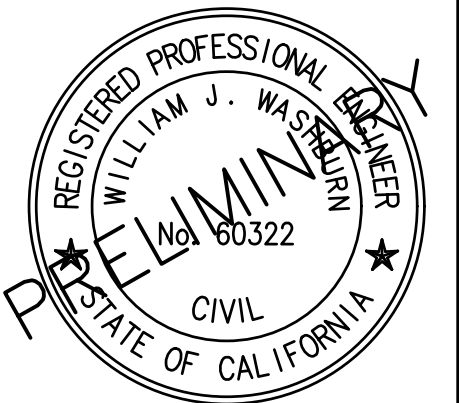

MATCH LINE STA 204+00
SEE SHEET 43

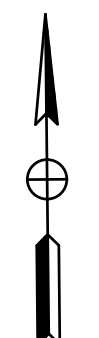

SCALE: 1" = 20'

HOUSTON AVENUE ATP CONNECTIVITY
HOUSTON AVENUE
PAVEMENT DELINEATION - STA 200+00 TO STA 204+00

CITY OF VISALIA
315 E. ACEQUIA AVENUE
VISALIA, CA 93291



PETERS ENGINEERING GROUP
862 POLLASKY AVENUE
CLOVIS, CALIFORNIA 93612
PHONE (559) 299-1544
WWW.PETERS-ENGINEERING.COM

DESIGN BY: CY
DRAWN BY: CY
CHECKED BY: WJW
DATE: 10-08-2025

SHEET NO. 42
TOTAL SHEETS XX

ORIGINAL SCALE IN INCHES FOR REDUCED PLANS

LEGEND & KEYNOTES (APPLIES TO SHEETS 42 TO 51)

- ⊠ XX LF PAVEMENT DELINEATION DETAIL & LENGTH (FEET) TO BE INSTALLED PER STATE STD. PLANS
- ① INSTALL 12" CROSSWALK STRIPING (WHITE, UNLESS NOTED OTHERWISE ON PLANS)
- ② INSTALL 12" LIMIT LINE STRIPING (WHITE, UNLESS NOTED OTHERWISE ON PLANS)
- STOP INSTALL "STOP" PAVEMENT MARKING PER STATE STD. PLAN A24D.
- LANE INSTALL "LANE" PAVEMENT MARKING PER STATE STD. PLAN A24D.
- BKE INSTALL "BIKE" PAVEMENT MARKING PER STATE STD. PLAN A24D.

- ↑ INSTALL BIKE LANE ARROW PAVEMENT MARKING PER REVISED STATE STD. PLAN RSP A24A
- ↩ INSTALL TYPE IV ARROW PAVEMENT MARKING PER REVISED STATE STD. PLAN RSP A24A
- ↗ INSTALL TYPE VI ARROW PAVEMENT MARKING PER REVISED STATE STD. PLAN RSP A24A
- ⊥ INSTALL PARKING SPACE PAVEMENT MARKING PER CA MUTCD 2014 FIGURE 3B-21
- ⊥ FURNISH & INSTALL SIGN AND POST AT THIS LOCATION

NOTES:

1. ALL EXIST PAVEMENT DELINEATION IN CONFLICT WITH PROPOSED PAVEMENT DELINEATION SHALL BE REMOVED BY WET SANDBLASTING OR OTHER APPROVED METHODS WHICH WILL CAUSE THE LEAST POSSIBLE DAMAGE TO THE PAVEMENT.
2. ALL STRIPING WORK SHALL BE DONE IN ACCORDANCE WITH THE LATEST EDITIONS OF THE STATE OF CALIFORNIA DEPARTMENT OF TRANSPORTATION STANDARD PLANS AND SPECIFICATIONS, THE 2014 CALIFORNIA MANUAL ON UNIFORM TRAFFIC CONTROL DEVICES (2014 CALIFORNIA MUTCD), UNLESS OTHERWISE DIRECTED BY THE CITY ENGINEER.
3. ALL PAVEMENT MARKINGS, CROSSWALKS, LIMIT LINES, TRAFFIC STRIPES SHALL BE PAINT (2 COATS) UNLESS OTHERWISE DIRECTED BY THE CITY.
4. THE CONTRACTOR IS RESPONSIBLE TO RECORD AND DOCUMENT AS NECESSARY EXISTING STRIPING, PAVEMENT MARKERS AND MARKINGS, BLUE DOT MARKERS FOR FIRE HYDRANTS IN ORDER TO REPLACE THE STRIPING, PAVEMENT MARKERS AND MARKINGS IN KIND.
5. THE PLANS ARE ACCURATE FOR STRIPING ONLY.

ROADWAY STRIPING SYMBOL LIST		
STRIPE #	DETAIL NUMBER	DESCRIPTION
⑨	DETAIL 9	7' DASHED WHITE WITH RPM
②②	DETAIL 22	DOUBLE SOLID YELLOW WITH RPM
④7B	DETAIL 27B	4" SOLID WHITE (RIGHT EDGE LINE)
④9	DETAIL 29	MEDIAN ISLAND WITH RPM
④31	DETAIL 31	TWO-WAY LEFT-TURN (YELLOW)
④38	DETAIL 38	8" CHANNELIZING WITH RPM
①	-	12" CROSSWALK
②	-	12" LIMIT LINE

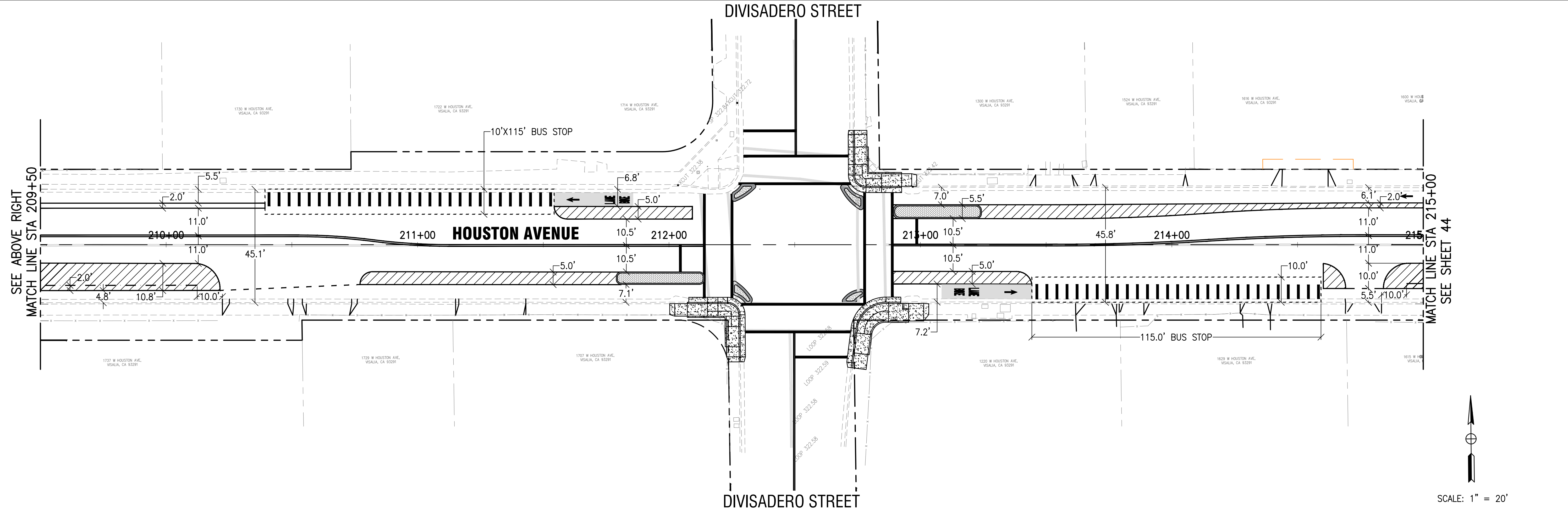
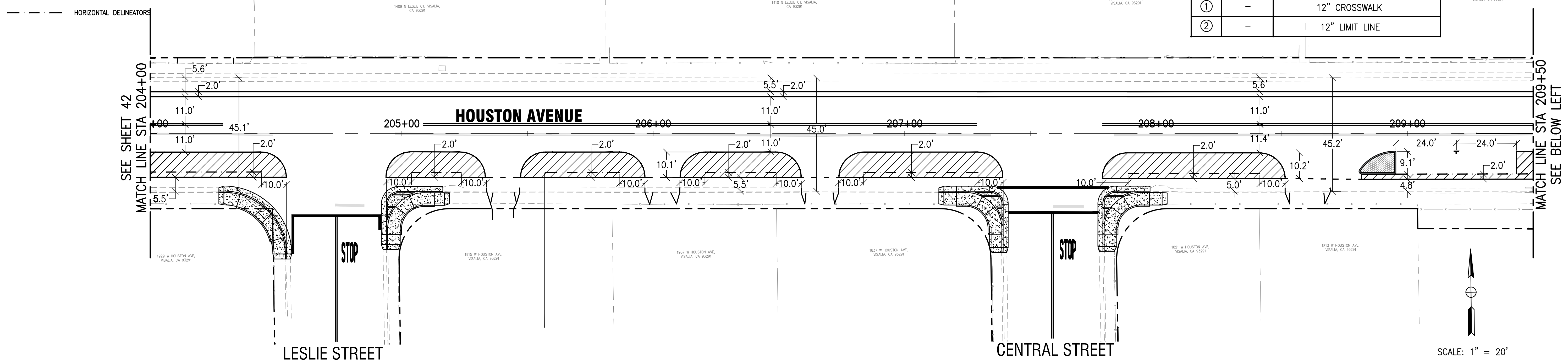

SCALE: 1" = 20'

SCALE: 1" = 20'

HOUSTON AVENUE ATP CONNECTIVITY
HOUSTON AVENUE
PAVEMENT DELINEATION - STA 204+00 TO STA 215+00

CITY OF VISALIA
315 E. ACEQUIA AVENUE
VISALIA, CA 93291

PETERS ENGINEERING GROUP
862 POLLASKY AVENUE
CLOVIS, CALIFORNIA 93612
PHONE (559) 299-1544
WWW.PETERS-ENGINEERING.COM

DESIGN BY: CY
DRAWN BY: CY
CHECKED BY: WJW
DATE: 10-08-2025

ORIGINAL SCALE IN INCHES
FOR REDUCED PLANS

SHEET NO. 43 TOTAL SHEETS XX

LEGEND & KEYNOTES (APPLIES TO SHEETS 42 TO 51)

- # XX LF PAVEMENT DELINEATION DETAIL & LENGTH (FEET) TO BE INSTALLED PER STATE STD. PLANS
- ① INSTALL 12" CROSSWALK STRIPING (WHITE, UNLESS NOTED OTHERWISE ON PLANS)
- ② INSTALL 12" LIMIT LINE STRIPING (WHITE, UNLESS NOTED OTHERWISE ON PLANS)
- STOP INSTALL "STOP" PAVEMENT MARKING PER STATE STD. PLAN A24D.
- LANE INSTALL "LANE" PAVEMENT MARKING PER STATE STD. PLAN A24D.
- BKE INSTALL "BIKE" PAVEMENT MARKING PER STATE STD. PLAN A24D
- ↑ INSTALL BIKE LANE ARROW PAVEMENT MARKING PER REVISED STATE STD. PLAN RSP A24A
- ↩ INSTALL TYPE IV ARROW PAVEMENT MARKING PER REVISED STATE STD. PLAN RSP A24A
- ↗ INSTALL TYPE VI ARROW PAVEMENT MARKING PER REVISED STATE STD. PLAN RSP A24A
- T INSTALL PARKING SPACE PAVEMENT MARKING PER CA MUTCD 2014 FIGURE 3B-21
- ↖ FURNISH & INSTALL SIGN AND POST AT THIS LOCATION

NOTES:

1. ALL EXIST PAVEMENT DELINEATION IN CONFLICT WITH PROPOSED PAVEMENT DELINEATION SHALL BE REMOVED BY WET SANDBLASTING OR OTHER APPROVED METHODS WHICH WILL CAUSE THE LEAST POSSIBLE DAMAGE TO THE PAVEMENT.
2. ALL STRIPING WORK SHALL BE DONE IN ACCORDANCE WITH THE LATEST EDITIONS OF THE STATE OF CALIFORNIA DEPARTMENT OF TRANSPORTATION STANDARD PLANS AND SPECIFICATIONS, THE 2014 CALIFORNIA MANUAL ON UNIFORM TRAFFIC CONTROL DEVICES (2014 CALIFORNIA MUTCD), UNLESS OTHERWISE DIRECTED BY THE CITY ENGINEER.
3. ALL PAVEMENT MARKINGS, CROSSWALKS, LIMIT LINES, TRAFFIC STRIPES SHALL BE PAINT (2 COATS) UNLESS OTHERWISE DIRECTED BY THE CITY.
4. THE CONTRACTOR IS RESPONSIBLE TO RECORD AND DOCUMENT AS NECESSARY EXISTING STRIPING, PAVEMENT MARKERS AND MARKINGS, BLUE DOT MARKERS FOR FIRE HYDRANTS IN ORDER TO REPLACE THE STRIPING, PAVEMENT MARKERS AND MARKINGS IN KIND.
5. THE PLANS ARE ACCURATE FOR STRIPING ONLY.

ROADWAY STRIPING SYMBOL LIST		
STRIPE #	DETAIL NUMBER	DESCRIPTION
⑨	DETAIL 9	7' DASHED WHITE WITH RPM
②②	DETAIL 22	DOUBLE SOLID YELLOW WITH RPM
④7B	DETAIL 27B	4" SOLID WHITE (RIGHT EDGE LINE)
④9	DETAIL 29	MEDIAN ISLAND WITH RPM
③1	DETAIL 31	TWO-WAY LEFT-TURN (YELLOW)
③8	DETAIL 38	8" CHANNELIZING WITH RPM
①	-	12" CROSSWALK
②	-	12" LIMIT LINE

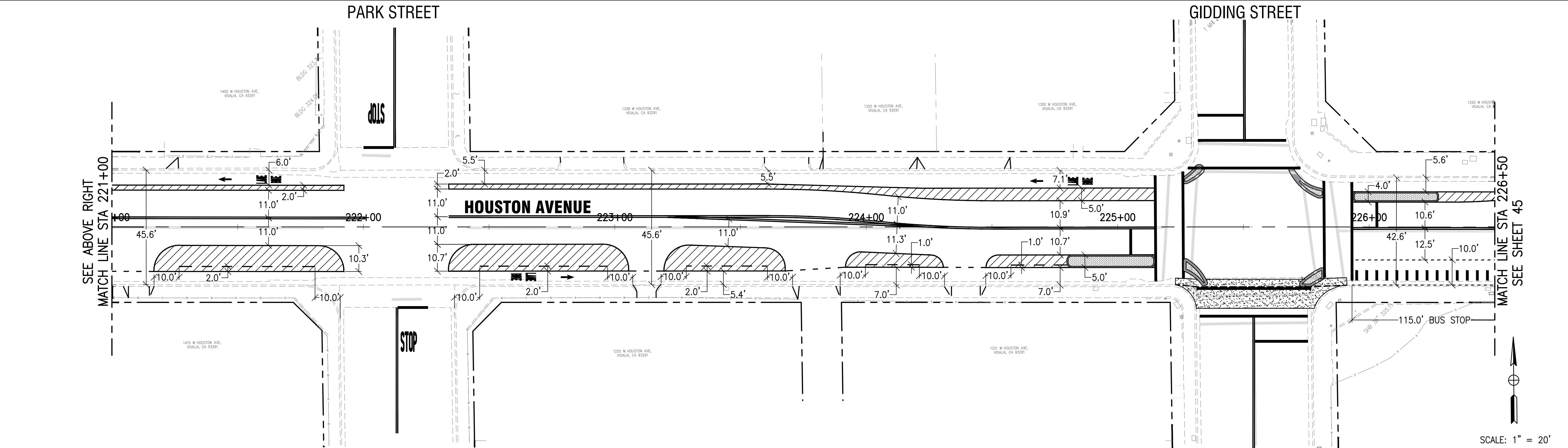
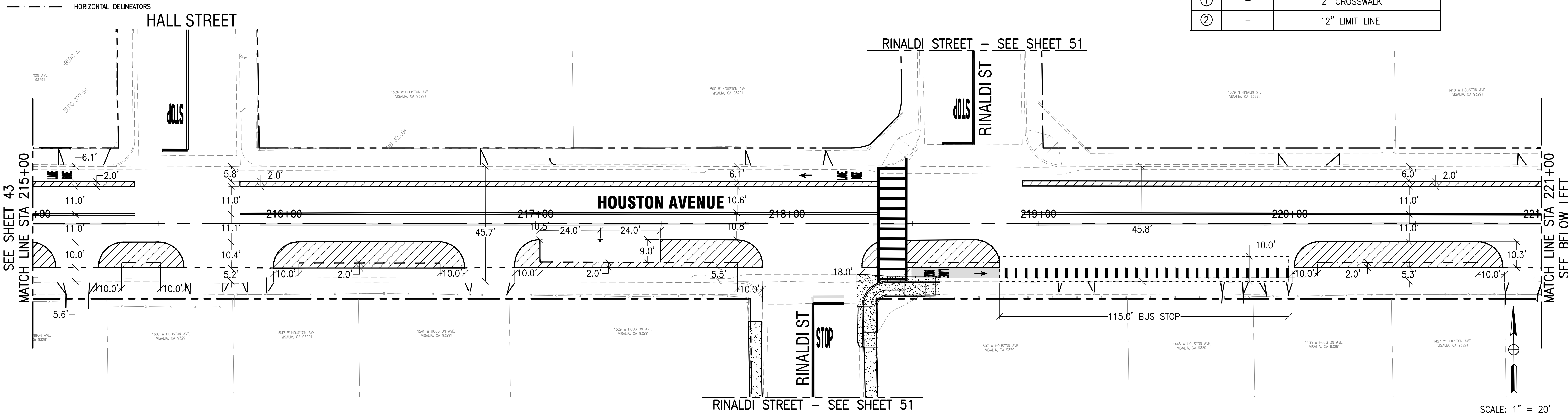

HOUSTON AVENUE ATP CONNECTIVITY
HOUSTON AVENUE
PAVEMENT DELINEATION - STA 215+00 TO STA 226+50

CITY OF VISALIA
315 E. ACEQUIA AVENUE
VISALIA, CA 93291

PETERS ENGINEERING GROUP
862 POLLASKY AVENUE
CLOVIS, CALIFORNIA 93612
PHONE (559) 299-1544
WWW.PETERS-ENGINEERING.COM

DESIGN BY: CY
DRAWN BY: CY
CHECKED BY: WJW
DATE: 10-08-2025

SHEET NO. 44
TOTAL SHEETS XX

ORIGINAL SCALE IN INCHES FOR REDUCED PLANS

LEGEND & KEYNOTES (APPLIES TO SHEETS 42 TO 51)

- #XX LF PAVEMENT DELINEATION DETAIL & LENGTH (FEET) TO BE INSTALLED PER STATE STD. PLANS
- ① INSTALL 12" CROSSWALK STRIPING (WHITE, UNLESS NOTED OTHERWISE ON PLANS)
- ② INSTALL 12" LIMIT LINE STRIPING (WHITE, UNLESS NOTED OTHERWISE ON PLANS)
- STOP INSTALL "STOP" PAVEMENT MARKING PER STATE STD. PLAN A24D.
- LANE INSTALL "LANE" PAVEMENT MARKING PER STATE STD. PLAN A24D.
- BKE INSTALL "BIKE" PAVEMENT MARKING PER STATE STD. PLAN A24D
- ↑ INSTALL BIKE LANE ARROW PAVEMENT MARKING PER REVISED STATE STD. PLAN RSP A24A
- ↩ INSTALL TYPE IV ARROW PAVEMENT MARKING PER REVISED STATE STD. PLAN RSP A24A
- ↗ INSTALL TYPE VI ARROW PAVEMENT MARKING PER REVISED STATE STD. PLAN RSP A24A
- T INSTALL PARKING SPACE PAVEMENT MARKING PER CA MUTCD 2014 FIGURE 3B-21
- ↖ FURNISH & INSTALL SIGN AND POST AT THIS LOCATION
- HORIZONTAL DELINEATORS

NOTES:

1. ALL EXIST PAVEMENT DELINEATION IN CONFLICT WITH PROPOSED PAVEMENT DELINEATION SHALL BE REMOVED BY WET SANDBLASTING OR OTHER APPROVED METHODS WHICH WILL CAUSE THE LEAST POSSIBLE DAMAGE TO THE PAVEMENT.
2. ALL STRIPING WORK SHALL BE DONE IN ACCORDANCE WITH THE LATEST EDITIONS OF THE STATE OF CALIFORNIA DEPARTMENT OF TRANSPORTATION STANDARD PLANS AND SPECIFICATIONS, THE 2014 CALIFORNIA MANUAL ON UNIFORM TRAFFIC CONTROL DEVICES (2014 CALIFORNIA MUTCD), UNLESS OTHERWISE DIRECTED BY THE CITY ENGINEER.
3. ALL PAVEMENT MARKINGS, CROSSWALKS, LIMIT LINES, TRAFFIC STRIPES SHALL BE PAINT (2 COATS) UNLESS OTHERWISE DIRECTED BY THE CITY.
4. THE CONTRACTOR IS RESPONSIBLE TO RECORD AND DOCUMENT AS NECESSARY EXISTING STRIPING, PAVEMENT MARKERS AND MARKINGS, BLUE DOT MARKERS FOR FIRE HYDRANTS IN ORDER TO REPLACE THE STRIPING, PAVEMENT MARKERS AND MARKINGS IN KIND.
5. THE PLANS ARE ACCURATE FOR STRIPING ONLY.

ROADWAY STRIPING SYMBOL LIST		
STRIPE #	DETAIL NUMBER	DESCRIPTION
⑨	DETAIL 9	7' DASHED WHITE WITH RPM
②②	DETAIL 22	DOUBLE SOLID YELLOW WITH RPM
④⑦B	DETAIL 27B	4" SOLID WHITE (RIGHT EDGE LINE)
④⑨	DETAIL 29	MEDIAN ISLAND WITH RPM
③①	DETAIL 31	TWO-WAY LEFT-TURN (YELLOW)
③⑧	DETAIL 38	8" CHANNELIZING WITH RPM
①	-	12" CROSSWALK
②	-	12" LIMIT LINE

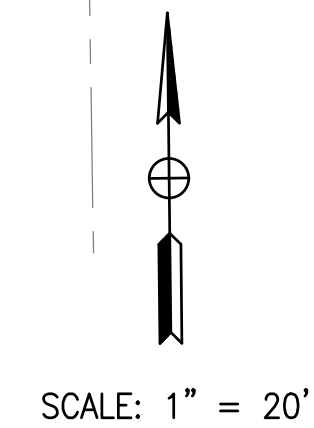
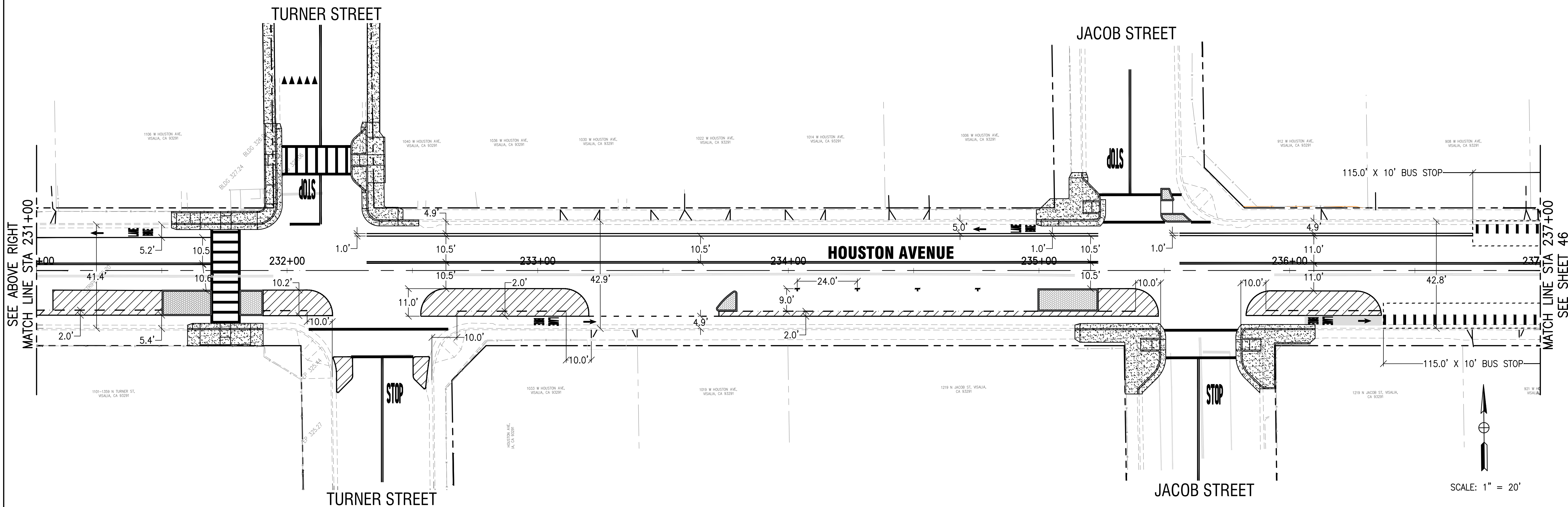
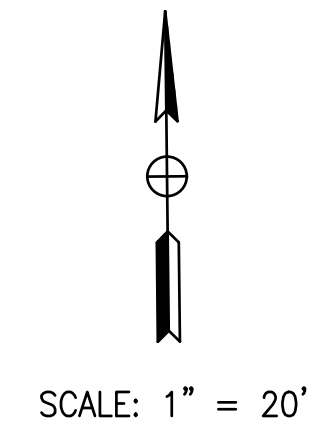
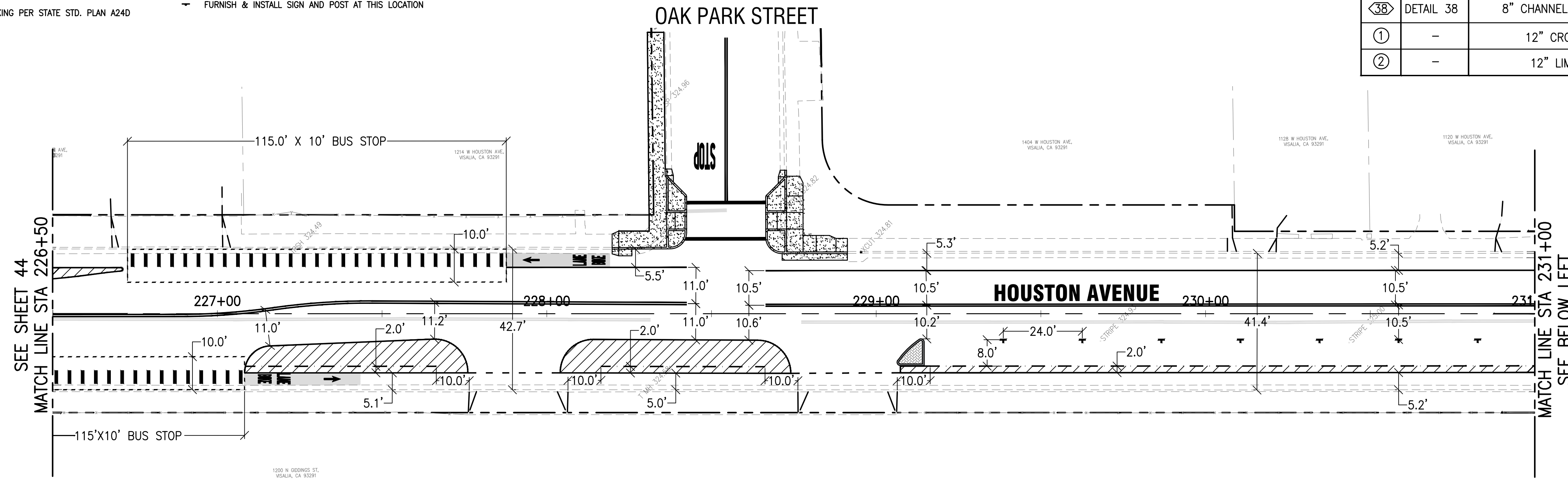

HOUSTON AVENUE ATP CONNECTIVITY
HOUSTON AVENUE
PAVEMENT DELINEATION - STA 226+50 TO STA 237+00

CITY OF VISALIA
315 E. ACEQUIA AVENUE
VISALIA, CA 93291

PETERS ENGINEERING GROUP
862 POLLASKY AVENUE
CLOVIS, CALIFORNIA 93612
PHONE (559) 299-1544
WWW.PETERS-ENGINEERING.COM

DESIGN BY: CY
DRAWN BY: CY
CHECKED BY: WJW
DATE: 10-08-2025

ORIGINAL SCALE IN INCHES FOR REDUCED PLANS

SHEET NO. 45	TOTAL SHEETS XX
--------------	-----------------

LEGEND & KEYNOTES (APPLIES TO SHEETS 42 TO 51)

- # XX LF Pavement delineation detail & length (feet) to be installed per state std. plans
- ① Install 12" crosswalk striping (white, unless noted otherwise on plans)
- ② Install 12" limit line striping (white, unless noted otherwise on plans)
- STOP Pavement marking per state std. plan A24D.
- LANE Pavement marking per state std. plan A24D.
- BIKE Pavement marking per state std. plan A24D.
- ↑ Install bike lane arrow pavement marking per revised state std. plan RSP A24A
- ↩ Install type IV arrow pavement marking per revised state std. plan RSP A24A
- ↗ Install type VI arrow pavement marking per revised state std. plan RSP A24A
- T Install parking space pavement marking per CA MUTCD 2014 figure 3B-21
- ⊙ Furnish & install sign and post at this location

ROADWAY STRIPING SYMBOL LIST		
STRIPE	DETAIL NUMBER	DESCRIPTION
◁#		
◁9	DETAIL 9	7" DASHED WHITE WITH RPM
◁22	DETAIL 22	DOUBLE SOLID YELLOW WITH RPM
◁27B	DETAIL 27B	4" SOLID WHITE (RIGHT EDGE LINE)
◁29	DETAIL 29	MEDIAN ISLAND WITH RPM
◁31	DETAIL 31	TWO-WAY LEFT-TURN (YELLOW)
◁38	DETAIL 38	8" CHANNELIZING WITH RPM
①	-	12" CROSSWALK
②	-	12" LIMIT LINE

NOTES:

1. ALL EXIST PAVEMENT DELINEATION IN CONFLICT WITH PROPOSED PAVEMENT DELINEATION SHALL BE REMOVED BY WET SANDBLASTING OR OTHER APPROVED METHODS WHICH WILL CAUSE THE LEAST POSSIBLE DAMAGE TO THE PAVEMENT.
2. ALL STRIPING WORK SHALL BE DONE IN ACCORDANCE WITH THE LATEST EDITIONS OF THE STATE OF CALIFORNIA DEPARTMENT OF TRANSPORTATION STANDARD PLANS AND SPECIFICATIONS, THE 2014 CALIFORNIA MANUAL ON UNIFORM TRAFFIC CONTROL DEVICES (2014 CALIFORNIA MUTCD), UNLESS OTHERWISE DIRECTED BY THE CITY ENGINEER.
3. ALL PAVEMENT MARKINGS, CROSSWALKS, LIMIT LINES, TRAFFIC STRIPES SHALL BE PAINT (2 COATS) UNLESS OTHERWISE DIRECTED BY THE CITY.
4. THE CONTRACTOR IS RESPONSIBLE TO RECORD AND DOCUMENT AS NECESSARY EXISTING STRIPING, PAVEMENT MARKERS AND MARKINGS, BLUE DOT MARKERS FOR FIRE HYDRANTS IN ORDER TO REPLACE THE STRIPING, PAVEMENT MARKERS AND MARKINGS IN KIND.
5. THE PLANS ARE ACCURATE FOR STRIPING ONLY.

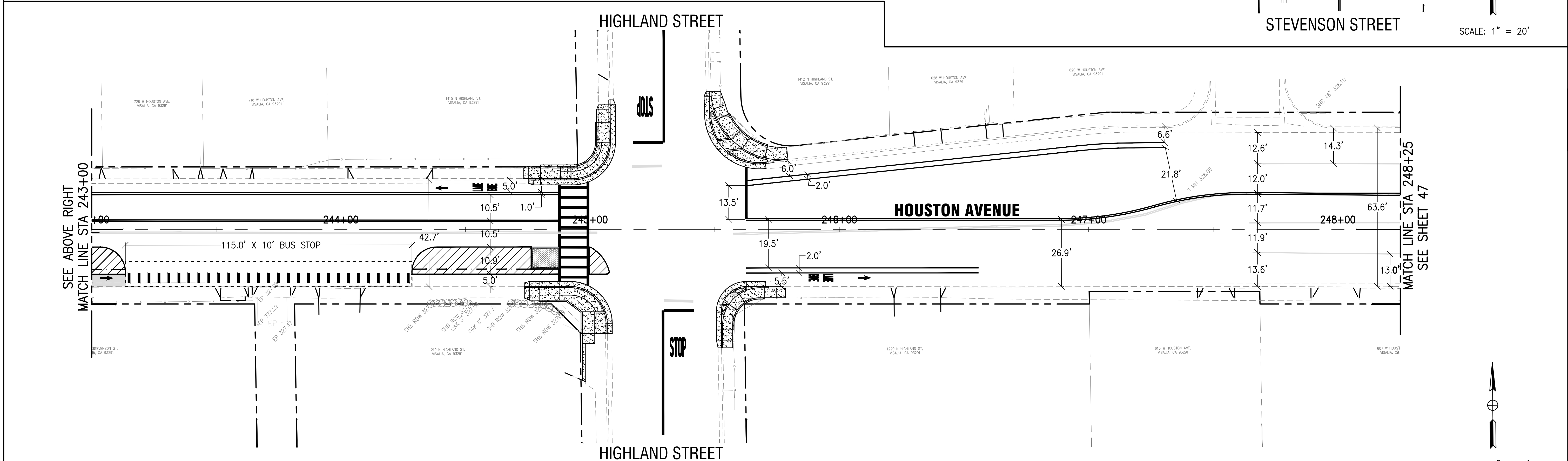
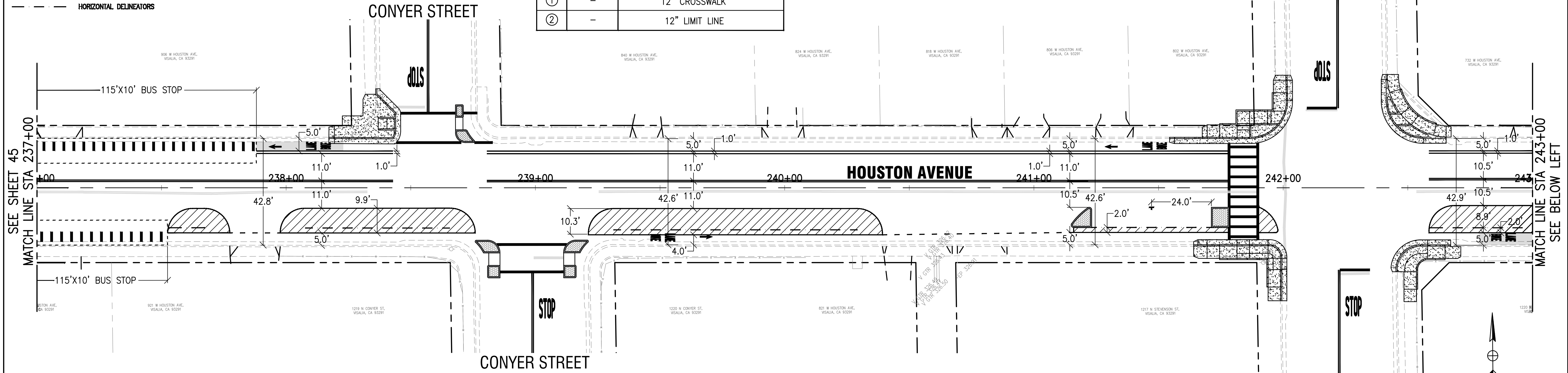
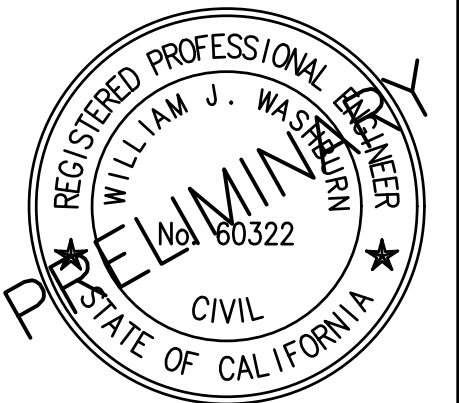

HOUSTON AVENUE ATP CONNECTIVITY
HOUSTON AVENUE
PAVEMENT DELINEATION - STA 237+00 TO STA 248+25

CITY OF VISALIA
315 E. ACEQUIA AVENUE
VISALIA, CA 93291

PETERS ENGINEERING GROUP
862 POLLASKY AVENUE
CLOVIS, CALIFORNIA 93612
PHONE (559) 299-1544
WWW.PETERS-ENGINEERING.COM

DESIGN BY: CY
DRAWN BY: CY
CHECKED BY: WJW
DATE: 10-08-2025

ORIGINAL SCALE IN INCHES
FOR REDUCED PLANS

SHEET NO. 46 TOTAL SHEETS XX

LEGEND & KEYNOTES (APPLIES TO SHEETS 42 TO 51)

- ⬠ XX LF PAVEMENT DELINEATION DETAIL & LENGTH (FEET) TO BE INSTALLED PER STATE STD. PLANS
- ① INSTALL 12" CROSSWALK STRIPING (WHITE, UNLESS NOTED OTHERWISE ON PLANS)
- ② INSTALL 12" LIMIT LINE STRIPING (WHITE, UNLESS NOTED OTHERWISE ON PLANS)
- STOP INSTALL "STOP" PAVEMENT MARKING PER STATE STD. PLAN A24D.
- LANE INSTALL "LANE" PAVEMENT MARKING PER STATE STD. PLAN A24D.
- BKE INSTALL "BIKE" PAVEMENT MARKING PER STATE STD. PLAN A24D

- ↑ INSTALL BIKE LANE ARROW PAVEMENT MARKING PER REVISED STATE STD. PLAN RSP A24A
- ↩ INSTALL TYPE IV ARROW PAVEMENT MARKING PER REVISED STATE STD. PLAN RSP A24A
- ↗ INSTALL TYPE VI ARROW PAVEMENT MARKING PER REVISED STATE STD. PLAN RSP A24A
- T INSTALL PARKING SPACE PAVEMENT MARKING PER CA MUTCD 2014 FIGURE 3B-21
- ⊙ FURNISH & INSTALL SIGN AND POST AT THIS LOCATION

--- HORIZONTAL DELINEATORS

NOTES:

1. ALL EXIST PAVEMENT DELINEATION IN CONFLICT WITH PROPOSED PAVEMENT DELINEATION SHALL BE REMOVED BY WET SANDBLASTING OR OTHER APPROVED METHODS WHICH WILL CAUSE THE LEAST POSSIBLE DAMAGE TO THE PAVEMENT.
2. ALL STRIPING WORK SHALL BE DONE IN ACCORDANCE WITH THE LATEST EDITIONS OF THE STATE OF CALIFORNIA DEPARTMENT OF TRANSPORTATION STANDARD PLANS AND SPECIFICATIONS, THE 2014 CALIFORNIA MANUAL ON UNIFORM TRAFFIC CONTROL DEVICES (2014 CALIFORNIA MUTCD), UNLESS OTHERWISE DIRECTED BY THE CITY ENGINEER.
3. ALL PAVEMENT MARKINGS, CROSSWALKS, LIMIT LINES, TRAFFIC STRIPES SHALL BE PAINT (2 COATS) UNLESS OTHERWISE DIRECTED BY THE CITY.
4. THE CONTRACTOR IS RESPONSIBLE TO RECORD AND DOCUMENT AS NECESSARY EXISTING STRIPING, PAVEMENT MARKERS AND MARKINGS, BLUE DOT MARKERS FOR FIRE HYDRANTS IN ORDER TO REPLACE THE STRIPING, PAVEMENT MARKERS AND MARKINGS IN KIND.
5. THE PLANS ARE ACCURATE FOR STRIPING ONLY.

ROADWAY STRIPING SYMBOL LIST		
STRIPE #	DETAIL NUMBER	DESCRIPTION
⑨	DETAIL 9	7' DASHED WHITE WITH RPM
②②	DETAIL 22	DOUBLE SOLID YELLOW WITH RPM
④7B	DETAIL 27B	4" SOLID WHITE (RIGHT EDGE LINE)
④9	DETAIL 29	MEDIAN ISLAND WITH RPM
④31	DETAIL 31	TWO-WAY LEFT-TURN (YELLOW)
④38	DETAIL 38	8" CHANNELIZING WITH RPM
①	-	12" CROSSWALK
②	-	12" LIMIT LINE

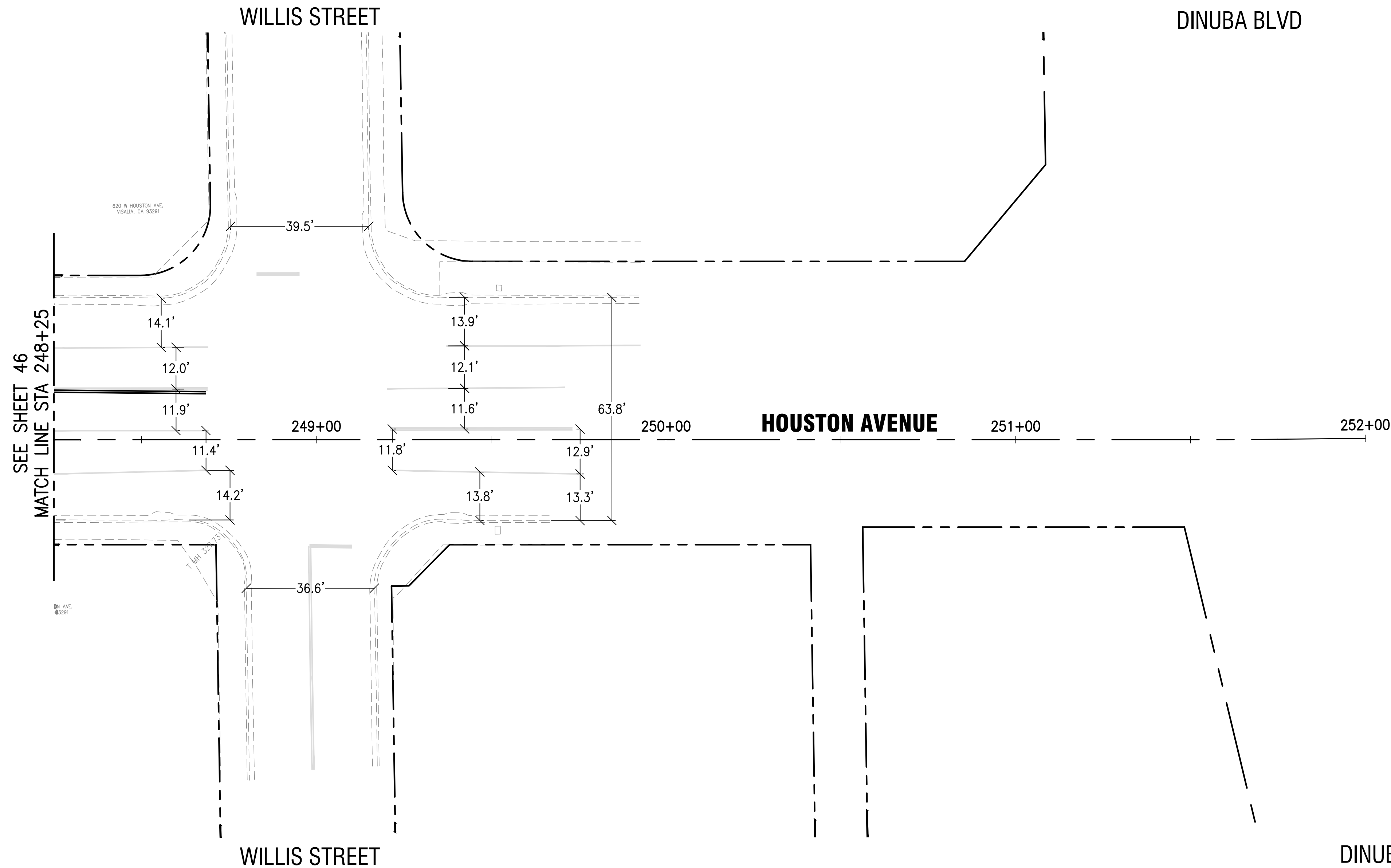

HOUSTON AVENUE ATP CONNECTIVITY
 HOUSTON AVENUE AND ALLEN AVENUE PAVEMENT DELINEATION
 HOUSTON AVENUE - STA 248+25 TO STA 252+00/
 ALLEN AVENUE - STA 12+00 TO STA 14+00

CITY OF VISALIA
 315 E. ACEQUIA AVENUE
 VISALIA, CA 93291

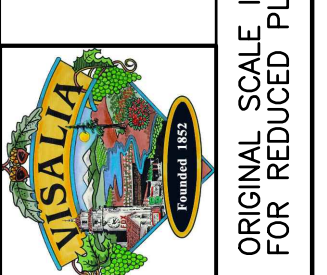

PETERS ENGINEERING GROUP
 862 POLLASKY AVENUE
 CLOVIS, CALIFORNIA 93612
 PHONE (559) 299-1544
 WWW.PETERS-ENGINEERING.COM

DESIGN BY: CY
 DRAWN BY: CY
 CHECKED BY: WJW
 DATE: 10-08-2025

SHEET NO. 47
 TOTAL SHEETS XX

